

SOUTHPORT MIDDLE SCHOOL

5715 S. Keystone Avenue

Indianapolis, IN 46227

317-789-4600

www.perryschools.org/sm

2023-2024

THIS STUDENT PLANNER BELONGS TO:

Name _____ Grade _____

Locker No. _____ Bus No. _____ Bus Row # _____ Slot # _____

PERRY TOWNSHIP VISION

Empowering students to grow academically, socially, and behaviorally

PERRY TOWNSHIP MISSION

Providing educational opportunities that create a desire for life-long learning that inspires all students to maximize their academic success

SOUTHPORT MIDDLE SCHOOL VISION

To empower our learners with the skills and integrity necessary to make a positive impact in their communities.

BELL SCHEDULE

Students are allowed in the building at 8:00 a.m. Students are tardy to school if not in the building by 8:12 a.m.

<u>Seventh Grade</u>	<u>(Wednesdays)</u>	<u>Eighth Grade</u>	<u>(Wednesdays)</u>
Advisory - 8:12	-	Advisory - 8:12	-
Period 1 – 8:38	(8:12)	Period 1 – 8:38	(8:12)
Period 2 – 9:27	(9:01)	Period 2 – 9:27	(9:01)
Period 3 – 10:15	(9:50)	Period 3 – 10:15	(9:50)
Period 4 – 11:04	(10:39)	Period 4 – 11:04*	(10:39*)
Period 5 – 11:54*	(11:30*)	Period 5 – 12:29	(12:03)
Period 6 – 1:20	(12:55)	Period 6 – 1:20	(12:55)
Period 7 – 2:09	(1:44)	Period 7 – 2:09	(1:44)
Dismissal – 2:55	(2:30)	Dismissal – 2:55	(2:30)
* Lunches during the 5th period		* Lunches during the 4th period	
* 12:12 or 12:46	(11:47 or 12:21)	* 11:04 or 11:38	(10:39 or 11:13)

Students are to go straight home after school hours unless participating in an adult supervised, school sponsored activity.

The information in this book was the best available at press time. Watch for additional information and changes.



powered by sdi innovations

No part of this publication may be reproduced, stored in a retrieval system, or transmitted in any form without getting prior written permission of the publisher.

© 2023. SDI Innovations. All Rights Reserved.

2880 OLD US HIGHWAY 231 S, LAFAYETTE IN 47909-2414 • 765.471.8883
www.schooldatebooks.com • sdi@schooldatebooks.com

TABLE OF CONTENTS

2023-2024 Perry Township Schools Calendar	3
2023-24 Important School Events	3
Absences	5
All School Communications	5
Athletics & Extra Curricular Activities.....	14
Behavior - Expected Student Conduct	10
Behavior - Student Misconduct.....	11
Bullying Policy	11
Burmese Notes.....	14
Bus - If You Miss It.....	11
Bus Conduct and Safety.....	11
Buses - Riding Other Than Assigned	11
Cafeteria	12
Cardinals S O A R.....	10
Chromebook Responsibility for Students	9
Closings, Delays & E-Learning	5
Communication - Promoting Success	4
Crisis Intervention Procedures	13
Doctor/Dentist Appointments.....	13
Eighth Grade Celebration	4
Emergency Information	13
Gang Activity Policy.....	11
Grading Scale.....	6
Health Related Items	12
Homework Information	6
I LEARN Testing	4
Instructional Media Center (IMC).....	9
Internet and Telecommunications Guidelines For Students	8
Late to School.....	12
Lockers	6
Medication Taken at School.....	13
Middle School Progress Reporting Calendar	4
Music Concerts.....	4
Personal Property at School.....	7
Pesticide Notification Registry	9
Pick-Up Times for School Events	14
Planner - Why Do We Issue One to Each Student.....	3
Progress Report Distribution	6
Riding Home with Parent/Relative	12
Selling Things in School	12
Sickness - Becoming Ill at School	13
Southport Middle School Honors Nights.....	4
Spanish Notes	15
Tardy Policy	12
Telephone Use.....	12
Textbooks	6
Unifrom Dress Policy Guidelines	7
Who to Contact? Possible Reasons	5
Withdrawing From School	12
Work Missed While Absent.....	6

PLANNER - WHY DO WE ISSUE ONE TO EACH STUDENT?

This School Calendar Planner has been designed to help each student manage their time and plan your day so that they can take a more proactive part in controlling your academic success

Southport Middle School Staff expects every student to:

- **Bring the planner to “Every Class, Every Day”**
- **Record assignments in their planners (may be checked)**

2023-2024 PERRY TOWNSHIP SCHOOLS CALENDAR

<https://www.perryschools.org/about/calendar/>

FIRST SEMESTER

July 24 & 25, 2023 (Mon. & Tues.)	Professional Meeting Days (No Students)
July 26, 2023 (Wednesday)	1st Day of School for Students
September 4 (Monday)	Labor Day Holiday
September 29 (Friday)	End 1st Nine Week Grading Period (47 days)
October 9 – 20 (2 weeks)	Fall Break/Intercession
November 22-24 (Wed., Thurs., & Fri.)	Thanksgiving Holiday
December 21 (Friday)	End 2nd Nine Week Grading Period (46 days)
	End 1st Semester – 93 Days/Last student day before break
December 22 (Thursday)	Teacher ½ Records Day
December 22 - January 5 (2 weeks)	Winter Break

SECOND SEMESTER

January 8, 2024 (Monday)	1st Day of 2nd Semester
January 15* (Monday)	Martin Luther King, Jr., Holiday-Make-up Day*
February 19* (Monday)	Presidents’ Day Holiday – Snow Make-Up Day*
March 8 (Friday)	End 3rd Nine Week Grading Period (43 days)
March 18 –29 (2 weeks)	Spring Break/Intercession
May 23 (Thursday)	End 4th Nine Week Grading Period (44 days)
	End 2nd Semester – 87 Days/Last Student Day
May 24 (Thursday)	Teacher 1/2 Record Day – Make Up Day If Needed

**If school is cancelled due to weather, make-up days may be utilized. That determination will be made up to one week prior to the holidays and by Feb. 18th for Spring Break. Minimum of 2 days required. If any days are used during spring break, for snow days, intersession will be cancelled.*

DATES: 2023-24 IMPORTANT SCHOOL EVENTS

BACK TO SCHOOL NIGHT	SCHOOL PICTURES	SPORTS
Tuesday, August 8, 2023, 6:00 PM	Tuesday, August 1, 2023	https://www.perryschools.org/sm/team-schedules/
VISION SCREENING (8th Gr)	HEARING SCREENING (7th Gr)	HIGH SCHOOL ORIENTATION
Mon., August 14-Wed. August 16	Mon., August 14-Wed. August 16	Wednesday, February 1, 2024, 6 PM at SHS

ILEARN TESTING

The window for the state standardized test, ILEARN, is April 15 to May 10, 2024. More specific dates and times during the test windows will be announced. It would be appreciated if parents would try not to schedule any appointments that would cause students to miss any of the testing. Both grades will be tested.

MIDDLE SCHOOL PROGRESS REPORTING CALENDAR

***Progress grades can be accessed online. Parents will be notified only of failing grades.**

Midterm Progress Report*

Communicated via Parent Square

End of Grading Period

September 29, 2023

December 21, 2023

March 8, 2024

May 23, 2024

Report Card Issued

Communicated via PS

Mailed upon request

MUSIC CONCERTS

8th Grade Band SHS Football Game Performance, Friday, September 29, 2023

7th/8th Grade Band Thursday, November 2, 2023, South Gym, 6:00 pm

7th/8th Grade Orchestra Tuesday, November 14, 2023, South Gym 6:30pm

ISSMA Solo/Ensemble Contest, Saturday, January 27, 2024

ISSMA 8th Grade Jazz Band Concert, Friday/Saturday, January 27, 2024

7th/8th Grade Orchestra, Thursday, March 8, 2024, South Gym 6:30pm

ISSMA Band Contest, Friday/Saturday, April 5/6

7th Grade Band, Tuesday, May 14, 2024, South Gym, 6:00pm

8th Grade Band, Thursday, May 16, 2024, SHS

7th/8th Grade Orchestra, Monday, May 22, 2023, South Gym, 6:30pm

Choir Dates TBD

SOUTHPORT MIDDLE SCHOOL HONORS NIGHTS

April 22 through May 17, 2024– Thirty-fourth Annual Doors of Honor

May, 2024 - 8th Grade President's Award Program – South Gym, 6:30 p.m.

EIGHTH GRADE CELEBRATION

Friday, May 17, 2024 7:30 - 10:00 p.m.

COMMUNICATION - PROMOTING SUCCESS

Student success depends upon his/her own efforts and the school and home working together and supporting each other. Communication between home and school is the key to student success. Although middle school students have so many different teachers each day compared to elementary school, communication need not lapse. Below are effective ways for parents to promote school communication and personal success in their children.

1. For individual classes, always contact that teacher first. Each teacher has a phone number and email address. See our website www.perryschools.org/sm.
2. Have your child ask his or her teacher to initial the assignments written in the Planner.
3. Check for homework assignments on Canvas
4. Visit your child's class(es).
5. Get grade updates online in Skyward at www.perryschools.org by using the parent login. Call our school Guidance Office at 317-789-4666.
6. Call your child's school counselor to schedule a conference with his/her teachers.

WHO TO CONTACT? POSSIBLE REASONS

Athletic Director's Office 317-789-4691

- Sport Physical Questions
- Digital Ticketing
- Athletic Questions / Concerns

Attendance Line 317-789-4605

- Early release
- Reporting absence

Clinic 317-789-4641

- Health Concern at School
- Medications Take at School

Main Office 317-789-4600

Student Services Office (Assistant Principal's / Guidance) 317-789-4666

- Attendance Questions
- Grade Questions
- Lost & Found
- Referrals
- Register / Withdraw
- Scheduling Questions
- Skyward Updates (Address/telephone changes)
- Social / Emotional Concerns

Treasurer's Office 317-789-4631

- Book Rental Fees, Chromebook Damage Fees

ALL SCHOOL COMMUNICATIONS

Each Friday, the *Cardinal Chronicle*, containing information of importance to you, will be published by the school. You may view the Cardinal Chronicle on our website at perryschools.org/sml/. Our district currently uses Parent Square to communicate with our families.

CLOSINGS, DELAYS & E-LEARNING

In the event of a delay or closing due to unforeseen circumstances (weather and emergencies), the superintendent will notify every family through our Parent Square communication system. The district will notify local radio and television stations as well. E-Learning schedule can be found on our school website perryschools.org/sml/ under "For Students" section.

ABSENCES

Regular attendance is a prerequisite for good education. **Parents should either call the 24-hour attendance number (317-789-4605), or report the absence in Skyward.** The reason for the absence should be reported in this phone call or via Skyward. If phone contact has not been made with the parent, the student **must** bring a parent note to Guidance Office upon returning to school. Athletes must be present by 11:00 in order to participate in an evening athletic activity.

Tuancy is the willful refusal of a student to attend school. Examples include, but are not limited to the following:

1. Leaving school for any reason without signing out or receiving permission from the office.
2. Student refuses to attend school.
3. Absence from school without prior permission from parent/guardian. This includes when a student misses the bus if the parent is unaware the student has missed the bus.
4. Absence from class without proper permission.

The policy for credit / no credit on completed work due to absence is listed below:

WORK MISSED WHILE ABSENT

When students are absent, they are expected to make up work. It is the **student's responsibility to request the assignments from each teacher. SMS allows one day to makeup work per one day of absence (i.e., 3 days absent = 3 school days to complete the missing work)**. This previous statement is for a maximum of 10 consecutive school days. Please contact your student's school guidance counselor for extended absences or other extenuating circumstances. Work not made up will be reflected in lower grades. **Students who have been ill or hospitalized** or will be absent **two or more days** because of illness may have needed materials sent home by contacting the school guidance counselor 317-789-4666. Teachers post assignments on Canvas, which can be accessed through our township homepage at www.perryschools.org. Your child can show you how to access the items in Canvas.

All make-up work due to absence must be communicated about by the student with the teacher after the student returns to school in order to receive full credit. If make-up work is assigned by the teacher, the student will receive full credit for that day's work. In-School Suspension and Out-of-School Suspension make-up work will receive full credit if completed and turned in. Major tests or projects may be made up for full credit for all absences except truancy.

Further information can be found in the Student Success Handbook booklet on the township website.

PROGRESS REPORT DISTRIBUTION

Parents are kept informed of their child's progress through our online grading portal (Skyward), parent conferences, mid-term reports, report cards, or telephone calls. Paper report cards are issued the Thursday following the completion of the first three grading periods and are posted to Skyward as well each quarter. Parents should note the dates on their calendar when mid-term reports and report cards are to be issued so they will know when to expect them. We do not mail report cards home.

GRADING SCALE

Grades are recorded in letters ranging from the highest A to the lowest F. The letter grades are used to indicate each student's progress. The "+" or "-" symbol is to be used only with the "B," "C," or "D" letter grade. The "-" symbol may also be used with the "A." This is in accordance with existing school district policy.

Grading scale is as follows: 93-100 = A 90-92 = A- 87-89 = B+ 83-86 = B 80-82 = B- 77-79 = C+
73-76 = C 70-72 = C- 67-69 = D+ 63-66 = D 60-62 = D- 50-59 = F

Major emphasis is also given to evaluate effort. Effort ratings ranging from the highest "1" to the lowest "5" are used to indicate each student's effort in relation to his/her potential according to the professional judgment of teachers.

HOMEWORK INFORMATION

- * Homework may be given Monday – Friday.
- * Long-term projects, unfinished homework, and make-up work may be done on weekends and short vacation periods.
- * No homework shall be given that requires students to work over longer vacation periods. These are defined as:
 1. Fall Break
 2. Thanksgiving Break
 3. Winter Break
 4. Spring Break

(This policy means that no assignments shall be due on the day students return from vacation periods listed above.)

- * Information on homework and class activities can be found in Canvas.

Further information can be found in the Student Success Handbook booklet on the township website.

ROSE HULMAN HOMEWORK HOTLINE (for math and science) – 1-877-275-7673; Sun-Thurs, 7-10 pm

LOCKERS

Each student will have the use of a hall locker. It is his/her responsibility to keep the locker in an orderly fashion. Students are not allowed to share lockers or to deface their locker in any manner. Food, drink or candy is not to be stored in the locker unless you pack your lunch. **Decals, pictures, mirrors, etc., are not to be attached to the outside nor inside of the lockers with any sticky material such as tape.** Students should not tell other students their locker combination. Lockers may be searched if it is deemed necessary. After the last student day, lockers are cleaned out the following week of summer. Physical education teachers will assign lockers in which physical education uniforms, towels, and shoes may be kept.

TEXTBOOKS

Textbooks are loaned to students for their use during the school year. Please write your full name on the textbook label, located on the inside of the front cover, in ink. Students are encouraged not to leave their books, school materials, or personal items unattended at any time. Students are expected to pay for damages to textbooks and for lost textbooks.

PERSONAL PROPERTY AT SCHOOL

If a student brings personal property to school, the student will be responsible for its safekeeping. Perry Township Schools does not authorize use of items or devices not required for school/school athletic use, during the day. Violations may result in discipline as well as confiscation. Personal electronic devices and accessories are to be shut off and put away during the school day. Cell phone use in the classroom is prohibited. All lost/found items should be turned in to the Student Services Office or to a staff member. The school is not responsible for lost or stolen items. *Further information can be found in the Student Success Handbook booklet on the township website.*

UNIFORM DRESS POLICY GUIDELINES

Students arrive to school in compliance with dress code and remain in compliance with dress code until arriving home after school. Administrators will take disciplinary action when students fail to adhere to the uniform dress policy. The administration reserves the right to determine what is considered inappropriate or disruptive to the educational process. Students are to wear the following apparel as it is intended to be worn. *"When in doubt, rule it out."*

TOPS

All tops, except sweaters and sweatshirts, must be tucked into bottoms. Tops may be long sleeve or short sleeve and must be solid color and free of stripes, patterns, or logo larger than a quarter. All under shirts (including t-shirts) must be solid color and worn under collared shirts. Additionally, acceptable tops must fall into the following categories:

- Oxford shirts, either short-sleeved or long-sleeved, with collars
- Polo shirts, either short-sleeved or long-sleeved, with collars
- Sweaters or sweatshirts without writing or artwork worn over collared shirts
- Southport Middle School spirit shirts, either short-sleeved or long-sleeved, with collars.
- Turtlenecks, either short-sleeved or long-sleeved, either regular or mock.

BOTTOMS

Clothing items worn as bottoms must be khaki dress pant style and black, navy blue, khaki or tan in color. Jean, jogging, legging, and sweatpants material are not accepted. Bottoms are not permitted to have the pant legs rolled up or gathered. Students may wear near knee length or longer pants from the beginning of the school year until Fall Break and again after Spring Break until the end of the school year.

Clothing items worn as bottoms may fall into the following categories:

- Near knee length or longer pants
- Skirts – Near knee length or longer (girls)
- Dress slacks

FOOTWEAR

Acceptable footwear includes any hard sole shoe with the entire foot covered (including toes and heel). Flip-flops, sandals, slippers and all other soft sole or slip-on shoes present safety issues and, therefore, will not be permitted.

OUTWEAR

Coats, hooded sweatshirts, zip-up/button-up jackets and all other outerwear must be stored in students' lockers during the school day.

Additional items that are not permitted include, but are not limited to the following:

- Hats, hoods, wave caps, bandanas and blankets
- Wallet chains
- Holes, rips, tears or cut clothing
- Writing on skin or clothing
- All types of bags and purses, which should be stored in lockers (students may carry one pencil bag to class)
- Any other items, if deemed a disruption or safety issue, such as rings or other adornments worn in the eyebrow, lip, or any other area

Further information can be found in the Student Success Handbook booklet on the township website.

SPIRIT DAYS

Occasionally, we will conduct Spirit days when students will be allowed to wear jeans free of holes, rips, tears, or inappropriate designs. Students will also be allowed to wear a red, white or black shirt (without a hood).

INTERNET AND TELECOMMUNICATIONS GUIDELINES FOR STUDENTS

STUDENT USAGE GUIDELINES:

It is important to remember that the use of the Internet is a privilege, not a right. Any infraction of the following usage guidelines may result in the revocation of Internet privileges.

1. All school use of the Internet must be in support of education and research and consistent with the mission of the Perry Township Schools.
2. Internet accounts are to be used only by the authorized owner of the account for authorized purposes.
3. Passwords must be guarded and protected. Users must not share their password with anyone or let others use it.
4. Users shall not reveal their home address or phone number or the addresses and phone numbers of others. Users must be cautious in responding to unsolicited online contact.
5. School Corporation Internet resources and accounts may not be used:
 - a. To access another person's materials, information, or files without permission.
 - b. To access, upload, download, distribute, or transmit pornographic, obscene, abusive, or sexually explicit language or material.
 - c. To violate any local, state, or federal statute.
 - d. To vandalize, damage, or disable the property of another person or organization.
 - e. To violate copyright, or otherwise use another person's intellectual property without his or her prior approval or citation.
 - f. For commercial or for-profit purposes.
 - g. For extensive personal and private business.
 - h. For product advertisement.
 - i. To access "chat rooms" and other forums which are devoid of any educational purpose.
 - j. To subscribe to or solicit information which incurs a cost.
6. Users shall not misrepresent other users on the network.
7. Electronic mail (e-mail) is not guaranteed to be private.
8. Malicious use of the network to develop programs that harass other users or infiltrate a computer or computing system and/or damage the software components of a computer or computing system is prohibited.
9. Subscriptions to Listserv must be reported to the Building Coordinator. Prior approval for Listserv is required for students.
10. Listserv mail must be monitored daily and deleted from the personal mail directory to avoid excessive use of fileserver hard-disk space.

From time to time, Perry Township Schools will make determinations on whether specific uses of the network are consistent with the acceptable use policy. Infringement on these guidelines will result in some, if not all, loss of Internet privileges as determined by the Building Coordinator or District System Administrator.

NOTE: Please contact the Student Services Office (317-789-4666) if you do NOT want Internet access for your child.

CHROMEBOOK RESPONSIBILITY FOR STUDENTS

The student is responsible for using reasonable care to maintain an undamaged, fully-charged Chromebook at all times. Perry Township Schools reserves the right to charge the full cost for repair or replacement when damage occurs due to gross negligence. Examples of gross negligence include, but are not limited to:

- Leaving equipment unattended and unlocked.
- Lending equipment to others.
- Using equipment in an unsafe manner or environment.
- In the event the Chromebook is lost or stolen, the Student and Parent will be billed the full cost of replacement.

Any fees assessed will take into account the manner in which the damage occurred and will be determined by the administration at Southport Middle School.

Item	District Cost*
Chromebook (missing, stolen, damaged beyond repair)	\$200
Screen replacement (cracks, dents)	\$50
Soft Case (damaged, smell, missing)	\$18
Charger (damaged, missing)	\$40
External damage to shell requiring replacement (dents, cracks, beauty issues)	\$50
Keyboard damage (missing keys, spills, marks)	\$65
Hinge Cover Removed/Missing	\$15

*Costs are subject to slight changes depending on current market price.

INSTRUCTIONAL MEDIA CENTER (IMC)

The IMC is open every school day during regular school hours. Students are encouraged to use the Media Center for research and to check out reading materials. A student coming to the IMC must have a teacher signed pass indicating the purpose(s) of the visit; the student is expected to come straight to the IMC without making any other stops. A student wishing to check out materials must have his/her ID card or student schedule to do so and should not have any overdue materials or fines. The student is responsible for all books and materials checked out on his or her ID card (or schedule), and the student will be charged for lost or damaged materials.

Books are loaned for a two-week period and may be renewed unless they are current Young Hoosier Book Award (YHBA) books. A student may have up to three items on loan at one time. The IMC staff expects materials to be returned promptly by the due date. Appropriate behavior is expected of all students using the IMC.

PESTICIDE NOTIFICATION REGISTRY

If parents need to be notified before pesticides are used on school grounds due to a child's medical condition, call 317-789-6200 to be placed on the notification registry.

BEHAVIOR – EXPECTED STUDENT CONDUCT

CARDINALS S O A R

SCHOOL-WIDE BEHAVIORAL EXPECTATIONS

	CLASSROOM	HALLWAY	RESTROOM	CAFE	TECHNOLOGY	EVENTS/ ASSEMBLY
Safety	<ol style="list-style-type: none"> 1. Keep hands, feet, and objects to yourself. 2. Only touch your own things. 	<ol style="list-style-type: none"> 1. Walk on the right side of the hallway. 2. Keep hands, feet, and objects to yourself. 3. Touch only your belongings. 	<ol style="list-style-type: none"> 1. Keep hands, feet, and objects to yourself. 2. Keep moving; avoid standing around. 	<ol style="list-style-type: none"> 1. Keep hands, feet, and objects to yourself. 2. Refrain from touching others food or trays. 3. Use food and utensils for intended purpose. 	<ol style="list-style-type: none"> 1. Use technology in a safe/positive way. 2. Report any concerning use of technology to a staff member. 3. Keep earbuds out of ears in the hallway. 	<ol style="list-style-type: none"> 1. Keep hands, feet, and objects to yourself while in your seat 2. Only touch your own belongings.
Ownership	<ol style="list-style-type: none"> 1. Be ready to start class when the bell rings. 2. Arrive prepared with all materials. 3. Follow dress code policies. 	<ol style="list-style-type: none"> 1. Organize and use your own locker. 2. Speak and act in a calm and controlled manner. 3. Follow dress code policies. 	<ol style="list-style-type: none"> 1. Wash/dry hands and leave facility clean. 2. Speak and act in a calm and controlled manner. 	<ol style="list-style-type: none"> 1. Arrive on time. 2. Keep your belongings under your seat. 3. Clean up your area before leaving. 4. Use best manners. 	<ol style="list-style-type: none"> 1. Keep your device in your own possession. 2. Be responsible for your device. 	<ol style="list-style-type: none"> 1. Arrive on time. 2. Be responsible for your actions. 3. Stay in control of your emotions and body.
Attentive	<ol style="list-style-type: none"> 1. Stay on task. 2. Raise hand to speak. 3. Follow teacher directions the first time. 	<ol style="list-style-type: none"> 1. Plan ahead to use locker and rest -room. 2. Display proper conduct. 3. Take the most direct route to your next destination. 	<ol style="list-style-type: none"> 1. If a student observes any spills, messes, or graffiti report it to your teacher. 	<ol style="list-style-type: none"> 1. Return /dispose of trays in an organized manner (single-file, clockwise rotation). 2. Stay seated unless given permission by an adult. 3. Sit in your assigned area. 	<ol style="list-style-type: none"> 1. Use technology when asked. 2. Use technology for activities efficiently. 3. Report any damages to your device immediately. 	<ol style="list-style-type: none"> 1. Quickly quiet down when asked. 2. Follow directions/prompts from the teacher. 3. Listen when others are speaking.
Respect	<ol style="list-style-type: none"> 1. Be kind, be positive. 2. Listen when others are speaking. 3. Take pride in school property. 	<ol style="list-style-type: none"> 1. Use kind words and actions. 2. Listen and respond appropriately to any directives from a staff member. 	<ol style="list-style-type: none"> 1. Use helpful, kind words. 2. Use facilities as intended. 	<ol style="list-style-type: none"> 1. Quickly get quiet when asked. 2. Refrain from touching others food or trays. 3. Follow directions of the adults. 4. Speak at a reasonable level. 	<ol style="list-style-type: none"> 1. Only touch your own device. 2. Use technology for academic purposes only. 3. Only use headphones when given permission. 	<ol style="list-style-type: none"> 1. Make positive decisions. 2. Celebrate achievements appropriately. Stay positive. 3. Take pride in school property and leave the area in better condition than you found it.

BEHAVIOR - STUDENT MISCONDUCT

The following rules and regulations will govern all students enrolled at Southport Middle School. Failure to comply with these rules shall constitute grounds for consequences from an Administrator including but not limited to: alternative to expulsion, classroom suspension, contracts, lunch detention, after-school detention, expulsion, in-school counseling, in-school suspension, parental conference, parental contact, mediation agreements, suspension, verbal reprimand, and work assignments.

Students will be held accountable for their choices. Perry Township Schools categorizes offenses in the following manner:

- Category I Offenses: (Misconduct)
- Category II Offenses: (Serious Misconduct)
- Category III Offenses: (Illegal Misconduct)

Further information can be found in the Student Success Handbook booklet on the township website.

BULLYING POLICY

The Perry Township Schools prohibits bullying as described in student discipline code IC 20-33-8-12. Bullying can be physical (hitting, kicking, shoving, etc.) verbal (taunting, teasing, racial slurs or verbal harassment) or non-verbal threatening (obscene gestures).

At Southport Middle School the Bully Prevention Committee has defined bullying as “deliberate physical or psychological abuse of an individual by one student or a group of students over time to create an ongoing pattern of harassment and abuse.”

Students should report any bullying to a school employee. Repeated acts of bullying will result in disciplinary action. Students at Southport Middle have also become proactive against bullying by making the “I Shine” pledge below. We hope each student can sincerely pledge the following:

- I – I will not hurt others with my words or actions.
- S – Stand up to putdowns.
- H – Help those who are being bullied.
- I – Inform adults when I need to.
- N – Never use my computer or cell phone to hurt others.
- E – Encourage my friends to stand up against bullying too.

Further information can be found in the Student Success Handbook booklet on the township website.

GANG ACTIVITY POLICY

For purposes of this policy, Perry Township Schools defines a gang as “any group of two or more persons who join together for destructive or violent purposes,” and/or as defined by IC 35-42-2-1.

The presence of gang and gang activities can cause a substantial disruption of and interference with the educational function of the school system. Perry Township Schools will not allow disruptive students to interfere with its educational function and responsibilities, and endeavors to maintain an atmosphere in the schools that is conducive to learning. Therefore, Perry Township Schools will not tolerate gangs or gang-like activities. Students are in violation of this policy if involved in substantiated gang related incidents and will be dealt with to the fullest extent allowed by the Perry Township Schools and the statutes of the State of Indiana.

BUS CONDUCT AND SAFETY

All students who ride a school bus should feel that they belong, are respected, and share the rights and privileges, as well as the responsibilities, of the entire bus load. Obeying the rules will better ensure the rights, safety, and well-being of all student passengers. Infractions of bus rules will result in disciplinary action, which may result in the loss of bus riding privileges.

Further information can be found in the Student Success Handbook on the township website.

BUSES – RIDING OTHER THAN ASSIGNED

Students are required to get off the bus at assigned stops and required to ride the same bus both morning and afternoon. When waiting for the bus, please remember, for safety, to stand 10 feet back from the roadway. A *Bus Waiver Request Form* must be submitted to the school for a student to change bus assignments or bus stops. Forms may be found on the transportation website, www.perryschools.org/departments/transportation/forms-resources.

BUS – IF YOU MISS IT

If you miss the bus, let your parents know immediately and make arrangements to get to school as soon as possible. Failure to reach school for this reason is an unexcused absence. 317-789-6220

RIDING HOME WITH PARENT/RELATIVE

If a student is to be picked up after school by a parent/relative instead of riding the bus home, **the student needs to meet his/her parent in front of the school.** Students should not be picked up by friends or non-relatives without parent permission.

SELLING THINGS IN SCHOOL

Selling, bartering, and/or trading of things in school is strictly prohibited. No candy, gum, cookies, or other items sold to make money for individual causes will be allowed.

TELEPHONE USE

Students will be permitted to use the telephone for emergency purposes only. Students will not be called out of class to use the phone unless it is an emergency. We do not consider forgotten lunch money, books, P.E. uniforms, homework or other school supplies, or for the purpose of staying with a friend, an emergency. Students must have permission from the Student Services Office to use the telephone. Students are to have made prior arrangements for pick up for all after-school activities.

CAFETERIA

Students are encouraged to put money into their accounts for breakfast, lunch and ala Carte purchases weekly or monthly. Cash will be accepted at the cash register daily to put into student accounts. Students, who wish to put money in their account by check, should report to the cafeteria in the morning during homeroom. The student's name and lunch number must be placed on the check. This is especially helpful if the student and parent last names are different. Payment on accounts may also be made with a Visa or MasterCard online at www.perryschools.org. Please allow 24 hours for online payments to be available in the student's account. Account balances may also be checked online. Negative balances are not permitted. Students with repeated insufficient funds in their accounts to pay for their meals will be referred to the principal for investigation. Peanut butter sandwich and milk are available upon request by the parent in emergency situations only. Please contact the school if you need assistance with your student's account or if you believe you qualify for financial assistance. Free and reduced applications are available online on the district website. **Please submit only one application per family.**

Students must purchase a meal before ala Carte items can be purchased. Milk may be purchased with a lunch from home. No off-campus food (including soft drinks) from restaurants may be brought into the cafeteria during lunchtime. All students are encouraged to eat a nutritious breakfast every day.

LATE TO SCHOOL

1. We expect our students to be on time to school every day.
2. Students arriving after 8:12 a.m. must report to the Main Office to sign in and receive an admission slip to class.
3. Continued tardiness will result in a referral being made to the Social Worker.

TARDY POLICY

It is important that the students develop the habit of being on time to class. Our school has developed a system of procedures and passes to enable students to conduct any necessary business without being late. Teachers will begin class instruction without having to stop, admit late students, and then begin again. Repeated tardiness to class may result in lunch detention, after-school detention, in-school suspensions, or out-of-school suspension. All tardies are documented in Skyward.

WITHDRAWING FROM SCHOOL

Parents should inform the Guidance Office in advance when withdrawing their child from school. **On the last day the student attends Southport, he or she should plan to stay the entire day.** All textbooks, Media Center materials, Chromebooks, and any other property belonging to the school must be returned. Copies of the withdrawal form and the health record will be given to the student to take to his/her new school. Additional records will be copied and sent to the new school upon written request from the school.

HEALTH RELATED ITEMS

1. Parents/Guardians must inform the school nurse and appropriate counselor of any serious health problems that might affect a student's participation in either physical education or classroom activities. This information needs to be provided in writing, on letterhead from the appropriate doctor's office. Also, the parents/guardians should list this information on the student's emergency cards.
2. **A doctor's statement is required for a student to be excused from physical activities for more than one day.**
3. **Marion County Health Department** technicians will continue to test the hearing of all seventh-grade students and special cases referred.
4. **Marion County Health Department** provides vision testing to all eighth-grade students and other special cases referred.
5. Scoliosis screening is performed by our township nursing staff on all seventh-grade students.
6. Speech therapy is available through RISE Special Services.

SICKNESS - BECOMING ILL AT SCHOOL

1. The student should report any illness to the teacher.
2. The teacher will refer the student to the Nurse's Office.
3. Only those listed on the emergency card can pick up the student.
4. Students leaving early due to illness may not return for any after-school activities.
5. **Remember: the student must have a pass to report to the Nurse's Office for a health problem.**

MEDICATION TAKEN AT SCHOOL

A **written parent request** is required for medication of any type (over-the-counter, prescriptions, creams, eye drops, etc.) to be taken at school. **All medications must be in the original container (including cough drops).** Only labeled directions will be followed. A doctor's order is required to alter any dosage. If it is absolutely necessary for any medication to be given at school, a duplicate bottle (*obtained from the pharmacy*) with the exact liquid amount or exact number of pills will be needed. All medications will be kept locked in the Nurse's Office. Students cannot keep medicine with them or in their lockers. A "**medicine pass**" will be issued to come to the nurse's office.

Inhalers must also be in the original box and be accompanied by written parent/guardian permission. Original box will have prescription label showing student's name, doctor's name, and dosage. If a student must carry an inhaler for use at school or for after-school activities due to severe asthma, we must have a **written parent note, as well as written physician's note or letter** stating the student has severe asthma and must carry the inhaler on his/her person. The student will self-administer the inhaler as prescribed.

Indiana Code IC 20-34-3-18 states that we may now release medications to the student to bring home from school with a **written note** from a parent or guardian. If you feel you have a safety concern or choose not to have your child transport medication to and from the Nurse's Office you may choose to continue to bring in or pick up the medication yourself. *Further information can be found in the Student Success Handbook booklet on the township website.*

DOCTOR/DENTIST APPOINTMENTS

Dental and medical appointments should be made at times to allow the student to miss the least amount of school time possible. We prefer a call from parents (317-789-4665), but will accept a student bringing a written note to the Guidance Office on the day of the appointment stating the purpose of the appointment and the time being picked up by the parent(s). The student will be given a "release pass" to leave class, get his/her materials, etc., and come down to the Main Office to sign out. The student should return to school if time permits and sign in at the Main Office to get an admit slip to class. Doctor and dentist appointments should ordinarily cause a student to miss only a part of his or her school day. Identification may be requested of the party picking up the student.

EMERGENCY INFORMATION

All emergency information, such as medical problems, parent/guardian name changes, address changes, workplace and/or phone number changes should be updated throughout the year. Parents can make any changes in Skyward or by contacting the Student Services Office by note or phone (317-789-4666). **Our automated phone system uses this emergency information to notify students and parents of emergencies and important information throughout the year.**

CRISIS INTERVENTION PROCEDURES

Perry Township Schools takes a proactive stance in dealing with the safety of its school children and personnel. Each school in Perry Township has in place a Crisis Intervention Plan, approved both by the Administration and the School Board, for dealing with a crisis situation should one occur. The major goals of a crisis intervention plan are to avoid panic and confusion in initial reactions to the crisis situation, to keep physical and/or psychological suffering to a minimum, to assist the school family in coping with a traumatic situation, and to restore the school to normal operation as soon as possible.

Principals instruct their staff members in the appropriate procedures to be followed in a variety of situations. Each school principal has the ability to reach parents in the event of a school emergency and the ability to deliver important school information in as timely a manner as possible by means of a program known as Parent Square. For this system to be effective, parents need to make sure that their contact information is up-to-date at all times in our database (Skyward).

ATHLETICS & EXTRA CURRICULAR ACTIVITIES

Interscholastic sports are provided for all students. In order for a student to be eligible to participate, he or she must meet certain scholastic requirements. Each student must have an updated IHSA physical on file issued by a physician, or nurse practitioner, and to have completed all online registration. Physical forms are available in the Athletic Office, Main Office, or online. SMS uses a digital ticketing process for most athletic events.

CONDUCT AT ATHLETIC EVENTS

Proper spectator conduct at athletic contests is expected. Consequences could include: removal from the event, suspension of attending future events, and possible prosecution for serious infractions.

1. Good sportsmanship means cheering our team and respecting the other school and game officials.
2. Students may **not** go to their lockers during or after the games.
3. Students will not be allowed to attend an athletic event if they leave school early because of illness or served an ALL-DAY ISS suspension on that day.

EXTRA-CURRICULAR ACTIVITIES

Students may be banned from attending extra-curricular events for the entire year or portions of the year by the administration because of school-related/behavioral issues.

Further information can be found in the Student Success Handbook booklet on the township website.

PICK-UP TIMES FOR SCHOOL EVENTS

Students are expected to have rides available at the conclusion of extracurricular events. Those students disregarding the pick-up times and who fail to have their rides available on time may be suspended from attending one or more events.

Pick-up time is typically around 7pm for most home athletic events.

BURMESE NOTES

Sianginn Thawngthanh (School Message)

Hringtu nu le pa le siangngakchia vialte, Southport Middle School in lunglawm tein kan in don hna.

Siangngakchia sinah (Students),

Hika sianginn hi na caah hlawhtlinnak le naa nuamhnak hmun a si lai tiah kan zumh. Cun nangmah holh (nu hrin holh) i na holh lengah Miraang holh (English) zong cawnnak nawl na ngei, hawikom tampi kawmh ding na ngeih fawn caah sianginn ah hin na nuam lai tiah kan zumh.

Nu le pa sinah (Parents),

Nu le pa le siangngakchia nih Southport Middle School kong hi nan theih ngai cang lai tiah kan zumh. Agenda timi cauk chungah hngalh a herhmi tampi an um. Biapituk an si caah lai holh in kan in lehpiak hna. Cu caah a tanglei ttialmi ca pawl hi nan rel dih hrimhrim lai.

Sianginn kainak (Attendance)

Siangngakchia caah cun bau lo tein sianginn kai hi biapi ngaingai a si. Na fanu/pa nih a damlo ruangah siseh, thil dang a herhmi pakhatkhat ruang ah siseh sianginn a kai khawh lo dingah ah cun sianginn ah thawng na thanh lai. Sianginn auhnak number cu 317-789-4605 a si lai. Nan auh tikah mi nih an tlaih lo ah cun bia (message) na chiah tak lai. Bia nan chiah tikah siangngakchia min hram, min dong kha fiang tein nan chim lai. Cun, cataang, zei ruangah a kai lo, nangmah kha zeitindah siangngakchia he nan i pehtlaih ti le na telephone number kha fiang tein na chimh hna lai.

Na fa cu sianginn a kai lo zongah a kai lo ni i an cawnni ca kha saya te nih tuahding an timi paoh cu a tuahdih a hau lai. Nihnih a si lo le ni hnih nak tam sianginn kai lo i a um ah cun 317-789-4665 ah zinglei nazi 8:00 hlan ah chawmh ding a si lai. Cun ca tuahding (homework) bawmh a herh ah cun <http://sm.msdp.k12.in.us> ah hin bawmhnak hal khawh a si. Student tinak khan na hmeh lai, cun taang 7 a si lole taang 8 ah na kal lai i teacher's assignment for the day ah khan bawmtu cu na hmuh khawh ko hna lai.

Thil hruk-aih ningcang (Dress Code)

Siangngakchia thil hruk-aihnak kong hi agenda cauk chungah fiang tein ttial a si. A biapimi cheukhat a tanglei ah kan hun fianter tthan. Siangngakchia nih sianginn i aa hrukmi thilthuum kha zanlei inn a phanh tiang aa hruk ding a si lai. Thil hruk ningcang cu a tanglei bantuinn an si lai:

Aangki (Tops)

Angki a tanglei a hleimi paoh cu tawhrolh (bawngbi) chungah khumh hrimhrim ding a si. Suaitta tahmi phun belte khumh lo in um khawh a si. Angki cu hngawng (collar) ngei a si lai. Muici/a zawng (color) pa khat lawng a si lai (a sen a si ah cun sen dih, a raang a si ah cun a raang dihmi a si lai). A ttialmi a si lai lo. Zuk le thil dangdang aa suaimi a si fawn lai lo. Baan tawi, baan sau cu duhmi paoh hman khawh a si.

Tawhroh/Bawngbii/Hniphor (Bottoms)

Bawngbii cu khakhi, tanatkha muici/ zawng a si lai. Jean le a dang dang bawngbii hruk khawh a si lai lo. Hniphor (skirt) cu khup tang tiang a khuhmi a si lai. Khua lum caan, August – October le April – May thla ah cun khup tiang a simi zong hruk khawh a si.

Kedan (Shoes)

Kepah a khuh dihmi kedan hmanding a si. Phanah (slippers)le ke hrohmi (sandals) phun hmankhawh a si lai lo. Hihi taksa venhinnak caah tuahmi a si.

Angki leng (Outerwear)

Khuasik tikah angki leng le thil lum nan i hrukmi paoh paoh cu thilchiahnak (locker) ah chiah dihdng a si lai. Sianginn khaan chungah hrukhawh a si lai lo.

Lentecelhnak (Athletics)

Lentecelhnak hi siangngakchia vialte caah tuahmi a si. Lentecelhnak ah tel a duhmi paoh nih phung ning tein tel a si. Lentecelhnak caah doctor nih a ngan a dam le dam lo a zoh hnu ah a dam ko tinak le nu le pa nih nawlpeknak minthutmi catlap cu sianginn zung (Main Office) a silo le Lentecelhnak zung (Athletics Office) ah saya te sinah pek tthan hnu lawngah lentecelhnak nawl hmuh a si.

Sianginn kharnak /Caan thawnnak (School Closing or Delays)

Thil pakhatkhat ruangah sianginn khar a silo le sainginn kaicaan thawh a si sual ah cun radio le TV in thawngthanhnak tuah a si lai. Cun sianginn website www.perryschools.org zongah zohkhawh a si. A silo le telephone in thawngthanhnak khawh kan in zuam hna lai.

Sii dinding le Nurse Zung (Medication & Nurse's Office)

Siangngakchia nih sianginn ah sii dinding ken a hauh ah cun nu le pa nih ca ttialpiak a hau. Sii a dinding cu amah min a ummi sii dur(original container) in ken ding a si lai. Sii cu Nurse zungkhan chungah chiah ding a si lai. Siangngakchia nih sii dinding kha amah tein ken/fim khawh a si lo. Locker zongah chiah khawh a si lo.

SPANISH NOTES

Asistencia (Attendance)

Si su hijo(a) está ausente, los padres deben reportar la ausencia de su hijo(a) llamando al **número de asistencia (317)789-4605**. En su mensaje debe incluir la razón por la ausencia. Si no puede dejar su mensaje en inglés, deje el mensaje en español. Para trabajo perdido mientras estuvo ausente busque en Canvas. Es la responsabilidad de los estudiantes averiguar el trabajo que han perdido. Los estudiantes tendrán la misma cantidad de días que estuvieron ausente para completar el trabajo..

Tarea es cualquier trabajo no terminado en clase. Es probable que los estudiantes tengan al menos una tarea cada noche. Cada noche su hijo(a) debe traer su agenda a casa. Si usted nota que hijo(a) no está trayendo tareas a casa o le gustaría saber su progreso en clases, por favor contacte a los maestros. **Las tareas están publicadas en cada sitio web de Canvas de cada maestro(a).**

Código de Vestimenta (Dress Code)

Los estudiantes deben llegar a la escuela cumpliendo el código de vestimenta y seguir cumpliendo el código de vestimenta hasta llegar a casa. La administración se reserva el derecho de determinar qué se considera inapropiado o perjudicial para el proceso educativo. “*Cuando en duda, descartar.*” Camisas con cuello de un solo color, suéteres sin dibujos o diseños. Los pantalones/ pantalones cortos deben ser pantalones de vestir y de color caqui, negro, azul marino o bronceado. No se aceptan jeans, jegging, leggings ni pantalones deportivos. El calzado aceptable incluye cualquier zapato de suela dura con todo el pie cubierto (incluidos los dedos y el talón). Chanclas, sandalias, pantuflas y cualquier otro calzado de suela blanda o sin cordones presentan problemas de seguridad y, por lo tanto, no se permitirán. Prendas exteriores como los abrigos, sudaderas con capucha, chaquetas con cremalleras/abotonadas y todas las demás prendas exteriores deben guardarse en los casilleros de los estudiantes durante el día escolar.

Atletico (Athletics)

Se proporcionan deportes interescolares para todos los estudiantes. Para que un estudiante sea elegible para participar, debe cumplir con ciertos requisitos escolares. Cada estudiante debe tener archivado un formulario físico emitido por un médico y un formulario de consentimiento de los padres completado. Estos formularios están disponibles en la oficina de deportes o en la oficina principal.

Cierre de la escuela o retrasos (School Closing or Delays)

En caso de una demora o cierre debido a circunstancias imprevistas (clima y emergencias), el superintendente notificará a cada familia a través de nuestro sistema telefónico automatizado. PARA QUE ESTE SISTEMA SEA EFECTIVO, LOS PADRES DEBEN MANTENER SU INFORMACIÓN DE CONTACTO ACTUALIZADA EN NUESTRA OFICINA DE SERVICIO ESTUDIANTIL. También notificaremos a las estaciones de radio y televisión locales. La información sobre cierres o retrasos también se publicará en nuestro sitio web en www.perryschools.org. Por favor, no llame a la escuela. Las líneas telefónicas son necesarias para llamadas de emergencia.

Medicación y Enfermería (Medication and Nurse's Office)

Se requiere una solicitud por escrito de los padres para que se tomen en la escuela medicamentos de cualquier tipo (de venta libre), recetas, cremas, gotas para los ojos, etc.). TODOS LOS MEDICAMENTOS deben estar en el ENVASE ORIGINAL (incluidas las pastillas para la tos). Todos los medicamentos se mantendrán bajo llave en la enfermería. Los estudiantes no pueden llevar medicamentos con ellos o en sus casilleros. Los inhaladores también deben estar en la caja original y estar acompañados por un permiso por escrito del padre / tutor.



CALENDAR YEARS

2023

January	S	M	T	W	T	F	S	February	S	M	T	W	T	F	S	March	S	M	T	W	T	F	S	April	S	M	T	W	T	F	S		
	1	2	3	4	5	6	7		1	2	3	4	1	2	3		4	1	2	3	4	5	6		7	8							
	8	9	10	11	12	13	14		5	6	7	8	9	10	11		5	6	7	8	9	10	11		9	10	11	12	13	14	15		
May	S	M	T	W	T	F	S	June	S	M	T	W	T	F	S	July	S	M	T	W	T	F	S	August	S	M	T	W	T	F	S		
	1	2	3	4	5	6	7		1	2	3	4	1	2	3		4	1	2	3	4	5	6		7	8							
	7	8	9	10	11	12	13		4	5	6	7	8	9	10		9	10	11	12	13	14	15		13	14	15	16	17	18	19		
September	S	M	T	W	T	F	S	October	S	M	T	W	T	F	S	November	S	M	T	W	T	F	S	December	S	M	T	W	T	F	S		
	1	2	3	4	5	6	7		1	2	3	4	5	6	7		1	2	3	4	5	6	7		1	2	3	4	5	6	7	8	9
	8	9	10	11	12	13	14		8	9	10	11	12	13	14		8	9	10	11	12	13	14		10	11	12	13	14	15	16		

2024

January	S	M	T	W	T	F	S	February	S	M	T	W	T	F	S	March	S	M	T	W	T	F	S	April	S	M	T	W	T	F	S			
	1	2	3	4	5	6	7		1	2	3	4	1	2	3		4	1	2	3	4	5	6		7	8								
	7	8	9	10	11	12	13		4	5	6	7	8	9	10		10	11	12	13	14	15	16		14	15	16	17	18	19	20			
May	S	M	T	W	T	F	S	June	S	M	T	W	T	F	S	July	S	M	T	W	T	F	S	August	S	M	T	W	T	F	S			
	1	2	3	4	5	6	7		1	2	3	4	5	6	7		1	2	3	4	5	6	7		1	2	3	4	5	6	7	8	9	
	7	8	9	10	11	12	13		8	9	10	11	12	13	14		14	15	16	17	18	19	20		18	19	20	21	22	23	24	25	26	27
September	S	M	T	W	T	F	S	October	S	M	T	W	T	F	S	November	S	M	T	W	T	F	S	December	S	M	T	W	T	F	S			
	1	2	3	4	5	6	7		1	2	3	4	5	6	7		1	2	3	4	5	6	7		1	2	3	4	5	6	7	8	9	
	8	9	10	11	12	13	14		8	9	10	11	12	13	14		10	11	12	13	14	15	16		15	16	17	18	19	20	21			

2025

January	S	M	T	W	T	F	S	February	S	M	T	W	T	F	S	March	S	M	T	W	T	F	S	April	S	M	T	W	T	F	S				
	1	2	3	4	5	6	7		1	2	3	4	5	6	7		1	2	3	4	5	6	7		1	2	3	4	5	6	7	8	9		
	8	9	10	11	12	13	14		8	9	10	11	12	13	14		10	11	12	13	14	15	16		13	14	15	16	17	18	19				
May	S	M	T	W	T	F	S	June	S	M	T	W	T	F	S	July	S	M	T	W	T	F	S	August	S	M	T	W	T	F	S				
	1	2	3	4	5	6	7		1	2	3	4	5	6	7		1	2	3	4	5	6	7		1	2	3	4	5	6	7	8	9		
	7	8	9	10	11	12	13		8	9	10	11	12	13	14		14	15	16	17	18	19	20		17	18	19	20	21	22	23	24	25	26	27
September	S	M	T	W	T	F	S	October	S	M	T	W	T	F	S	November	S	M	T	W	T	F	S	December	S	M	T	W	T	F	S				
	1	2	3	4	5	6	7		1	2	3	4	5	6	7		1	2	3	4	5	6	7		1	2	3	4	5	6	7	8	9		
	8	9	10	11	12	13	14		8	9	10	11	12	13	14		10	11	12	13	14	15	16		14	15	16	17	18	19	20				

JULY 2023

MONDAY 24

TUESDAY 25

WEDNESDAY 26

July 27, 1921 – At the University of Toronto, Canadian scientists successfully isolate insulin – a hormone they believe can prevent diabetes – for the first time.

THURSDAY 27

FRIDAY 28

SATURDAY 29

SUNDAY 30

AUGUST 2023

MONDAY 31

TUESDAY 1

Southport Middle School Picture
Day

WEDNESDAY 2

August 3, 1958 – The U.S. nuclear submarine *Nautilus* accomplishes the first undersea voyage to the geographic North Pole.

THURSDAY 3

FRIDAY 4

SATURDAY 5

SUNDAY 6

AUGUST 2023

MONDAY 7

TUESDAY 8

6:00 PM - 8:00 PM - Southport
Middle School Back to School
Night

WEDNESDAY 9

August 13, 1899 – English film director Alfred Hitchcock is born.

THURSDAY 10

FRIDAY 11

SATURDAY 12

SUNDAY 13

AUGUST 2023

MONDAY 14

8:00 AM - 3:00 PM - Southport
Middle School Hearing/Vision
Screening

5:30 PM - 6:30 PM - Volleyball (8th)
Girls vs Greenfield Central Jr
High School (Home)

5:30 PM - 7:30 PM - Volleyball (7th)
Girls vs Greenfield Central Jr
High School (Home)

TUESDAY 15

5:30 PM - 6:30 PM - Cross Country
(Coed MS) vs Perry Meridian
Middle School (Home)

5:30 PM - 6:30 PM - Soccer (Girls
MS) vs Belzer Middle School
(Home)

6:45 PM - 7:45 PM - Soccer (Boys
MS) vs Belzer Middle School
(Home)

WEDNESDAY 16

6:00 PM - 7:00 PM - Football
(7th) vs John Wooden Middle
School (Home)

THURSDAY 17

5:30 PM - 6:30 PM - Soccer (Girls MS) vs Franklin Central Junior High (Home)
5:30 PM - 7:30 PM - Volleyball (7th) Girls vs Franklin Community Middle School (Away)
6:00 PM - 7:00 PM - Football (8th) vs John Wooden Middle School (Away)
6:30 PM - 7:30 PM - Volleyball (8th) Girls vs Franklin Community Middle School (Away)
6:45 PM - 7:45 PM - Soccer (Boys MS) vs Franklin Central Junior High (Home)

FRIDAY 18

SATURDAY 19

9:00 AM - 10:00 AM - Cross Country (Coed MS) vs Franklin Central Junior High High Flash Dash (Away)

SUNDAY 20

AUGUST 2023

MONDAY 21

5:30 PM - 6:30 PM - Soccer (Girls MS) vs Greenfield Central Jr High School (Away)

5:30 PM - 6:30 PM - Tennis (Boys MS) vs New Palestine Junior High (Home)

5:30 PM - 6:30 PM - Volleyball (7th) Girls vs New Palestine Junior High (Home)

6:30 PM - 7:30 PM - Volleyball (8th) Girls vs New Palestine Junior High (Home)

6:45 PM - 7:45 PM - Soccer (Boys MS) vs Greenfield Central Jr High School (Away)

TUESDAY 22

5:30 PM - 6:30 PM - Volleyball (7th) Girls vs Speedway Junior High School (Home)

WEDNESDAY 23

5:30 PM - 6:30 PM - Soccer (Girls MS) vs Franklin Community Middle School (Away)

6:00 PM - 7:00 PM - Football (7th) vs Zionsville West Middle School (Home)

6:45 PM - 7:45 PM - Soccer (Boys MS) vs Franklin Community Middle School (Away)

August 21, 1911 – After spending the night hiding in a closet, three men walk out of the Louvre in Paris with the “Mona Lisa.” It’s recovered two years later.

THURSDAY 24

5:30 PM - 6:30 PM - Volleyball (7th)
Girls vs Clark-Pleasant Middle School (Home)
5:45 PM - 6:45 PM - Football (8th)
vs Zionsville West Middle School (Away)
5:45 PM - 6:45 PM - Tennis (Boys MS) vs Greenfield Central Jr High School (Away)
6:15 PM - 7:15 PM - Volleyball (8th)
Girls vs Clark-Pleasant Middle School (Home)

FRIDAY 25

SATURDAY 26

SUNDAY 27

AUGUST 2023

MONDAY 28

TUESDAY 29

- 5:15 PM - 6:15 PM - Tennis (Boys MS) vs Franklin Central Junior High (Away)
- 5:30 PM - 6:30 PM - Soccer (Girls MS) vs New Palestine Junior High (Away)
- 5:30 PM - 6:30 PM - Volleyball (7th) Girls vs Creston Intermediate & Middle School (Away)
- 6:30 PM - 7:30 PM - Soccer (Boys MS) vs New Palestine Junior High (Away)
- 6:30 PM - 7:30 PM - Volleyball (8th) Girls vs Creston Intermediate & Middle School (Away)

WEDNESDAY 30

- 5:30 PM - 7:30 PM - Football (7th) vs Beech Grove Middle School (Home)
- 7:00 PM - 8:00 PM - Football (8th) vs Beech Grove Middle School (Home)

August 31, 1955 – The world's first solar-powered car is demonstrated at the General Motors Powerama in Chicago.

THURSDAY 31

5:00 PM - 6:00 PM - Golf (Girls MS) vs Decatur Middle School (Away)
5:30 PM - 6:30 PM - Cross Country (Coed MS) vs Greenfield Central Jr High School, Shelbyville Middle School (Home)
5:30 PM - 6:30 PM - Volleyball (7th) Girls vs Franklin Central Junior High (Home)
6:30 PM - 7:30 PM - Volleyball (8th) Girls vs Franklin Central Junior High (Home)

FRIDAY 1

8:30 AM - 10:00 AM - Southport Middle School Southport Sprint

SATURDAY 2

SUNDAY 3

SEPTEMBER 2023

MONDAY 4

Labor Day

TUESDAY 5

5:30 PM - 6:30 PM - Cross Country
(Coed MS) vs Franklin Central
Junior High, Center Grove
Middle School North (Away)
5:30 PM - 6:30 PM - Soccer (Boys
MS) vs Heritage Christian
Schools (Home)
5:30 PM - 6:30 PM - Tennis (Boys
MS) vs Decatur Middle School
(Away)

WEDNESDAY 6

5:30 PM - 6:30 PM - Football (7th)
vs Greenfield Central Jr High
School (Home)
6:45 PM - 7:45 PM - Football (8th)
vs Greenfield Central Jr High
School (Home)

September 4, 1882 – Thomas Edison illuminates 400 electric lights on the streets of lower Manhattan in New York City in the first mass lighting of electric light bulbs.

THURSDAY 7

5:30 PM - 6:30 PM - Cross Country (Coed MS) vs Beech Grove Middle School, New Palestine Junior High (Away)
5:30 PM - 6:30 PM - Soccer (Girls MS) vs Perry Meridian Middle School (Home)
5:30 PM - 6:30 PM - Tennis (Boys MS) vs Belzer Middle School (Home)
5:30 PM - 6:30 PM - Volleyball (7th) Girls county 2nd round (Home)
6:30 PM - 7:30 PM - Soccer (Boys MS) vs Perry Meridian Middle School (Home)
6:30 PM - 7:30 PM - Volleyball (8th) Girls county 2nd round (Home)

FRIDAY 8

SATURDAY 9

SUNDAY 10

SEPTEMBER 2023

MONDAY 11

Patriot Day

- 5:00 PM - 6:00 PM - Golf (Girls MS) vs Franklin Central Junior High (Home)
- 5:30 PM - 6:30 PM - Tennis (Boys MS) vs Perry Meridian Middle School (Away)
- 5:30 PM - 6:30 PM - Volleyball (7th) Girls vs Greenwood Christian Academy (Away)
- 5:45 PM - 6:45 PM - Soccer (Girls MS) vs Plainfield Community Middle School (Away)
- 6:30 PM - 7:30 PM - Volleyball (8th) Girls vs Greenwood Christian Academy (Away)
- 7:00 PM - 8:00 PM - Soccer (Boys MS) vs Plainfield Community Middle School (Away)

TUESDAY 12

- 5:30 PM - 6:30 PM - Cross Country (Coed MS) vs Fall Creek Valley Middle School, Zionsville West Middle School (Home)
- 5:30 PM - 6:30 PM - Soccer (Girls MS) vs Heritage Christian Schools (Away)
- 5:30 PM - 6:30 PM - Tennis (Boys MS) vs Greenwood Middle School (Away)
- 5:30 PM - 8:30 PM - Volleyball (7th) Girls vs Perry Meridian Middle School (Home)
- 6:00 PM - 7:00 PM - Football (7th) vs Franklin Central Junior High (Away)
- 6:00 PM - 7:00 PM - Football (8th) vs Franklin Central Junior High (Home)
- 6:30 PM - 7:30 PM - Volleyball (8th) Girls vs Perry Meridian Middle School (Home)

WEDNESDAY 13

September 16, 1620 – The *Mayflower* sails from Plymouth, England, bound for the New World with 102 passengers on board.

THURSDAY 14

5:30 PM - 6:30 PM - Soccer (Boys MS) vs Fall Creek Valley Middle School (Away)
5:30 PM - 6:30 PM - Soccer (Girls MS) vs Fall Creek Valley Middle School (Home)
5:30 PM - 6:30 PM - Tennis (Boys MS) vs Fall Creek Valley Middle School (Away)
5:30 PM - 6:30 PM - Volleyball (7th) Girls vs Paul Hadley Middle School (Away)
6:30 PM - 7:30 PM - Volleyball (8th) Girls vs Paul Hadley Middle School (Away)

FRIDAY 15

Rosh Hashanah begins at sundown

SATURDAY 16

8:30 AM - 9:30 AM - Cross Country (Coed MS) Brown County Invitational (Away)

SUNDAY 17

SEPTEMBER 2023

MONDAY 18

- 5:30 PM - 6:30 PM - Soccer (Boys MS) vs Shelbyville Middle School (Home)
- 5:30 PM - 6:30 PM - Soccer (Girls MS) vs Shelbyville Middle School (Away)

TUESDAY 19

- 5:30 PM - 6:30 PM - Cross Country (Coed MS) vs New Augusta Public Academy, Lynhurst 7th & 8th Grade Center, Zionsville West Middle School (Away)
- 5:30 PM - 6:30 PM - Tennis (Boys MS) vs Lynhurst 7th & 8th Grade Center (Home)
- 5:30 PM - 6:30 PM - Volleyball (7th) Girls vs John Wooden Middle School (Home)
- 6:45 PM - 7:45 PM - Volleyball (8th) Girls vs John Wooden Middle School (Home)

WEDNESDAY 20

- 5:30 PM - 6:30 PM - Soccer (Girls MS) vs Paul Hadley Middle School (Away)
- 6:00 PM - 7:00 PM - Football (7th) vs Speedway Junior High School (Away)
- 6:45 PM - 7:45 PM - Soccer (Boys MS) vs Paul Hadley Middle School (Away)
- 7:00 PM - 8:00 PM - Football (8th) vs Speedway Junior High School (Away)

September 21, 1937 – J.R.R. Tolkien publishes *The Hobbit*. His epic trilogy, *The Lord of the Rings*, which takes him 10 years to write, is not published until 1954.

THURSDAY 21

5:30 PM - 6:30 PM - Tennis (Boys MS) vs Raymond Park Middle School (Away)

FRIDAY 22

SATURDAY 23

First day of autumn

SUNDAY 24

Yom Kippur begins at sundown

SEPTEMBER 2023

MONDAY 25

5:30 PM - 6:30 PM - Tennis (Boys MS) vs Shelbyville Middle School (Home)

TUESDAY 26

Mawlid al-Nabi begins at sundown

5:30 PM - 6:30 PM - Tennis (Boys MS) vs New Augusta Public Academy (Away)

5:30 PM - 6:30 PM - Volleyball (7th) Girls vs Beech Grove Middle School (Home)

6:30 PM - 7:30 PM - Volleyball (8th) Girls vs Beech Grove Middle School (Home)

WEDNESDAY 27

5:30 PM - 6:30 PM - Football (7th) vs St. Jude Catholic School (Home)

6:45 PM - 7:45 PM - Football (8th) vs St. Jude Catholic School (Home)

September 25, 1957 – Weeks after Gov. Orval Faubus tries to prevent racial integration, the U.S. Army escorts nine Black students into all-white Central High School in Little Rock, Arkansas.

THURSDAY 28

5:30 PM - 6:30 PM - Volleyball (7th)
Girls vs Decatur Middle School
(Away)
6:30 PM - 7:30 PM - Volleyball (8th)
Girls vs Decatur Middle School
(Away)

FRIDAY 29

SATURDAY 30

SUNDAY 1

OCTOBER 2023

MONDAY 2

TUESDAY 3

WEDNESDAY 4

5:30 PM - 6:30 PM - Football (7th)
vs Perry Meridian Middle
School (Away)

7:00 PM - 8:00 PM - Football (8th)
vs Perry Meridian Middle
School (Away)

October 4, 1957 – The Soviet Union launches *Sputnik*, the world's first artificial satellite; thus begins the Space Age.

THURSDAY 5

FRIDAY 6

SATURDAY 7

SUNDAY 8

OCTOBER 2023

MONDAY 9

Columbus Day

TUESDAY 10

WEDNESDAY 11

October 12, 1492 – Christopher Columbus lands at an island in the Bahamas, believing that he has reached East Asia.

THURSDAY 12

FRIDAY 13

SATURDAY 14

SUNDAY 15

OCTOBER 2023

MONDAY 16

TUESDAY 17

WEDNESDAY 18

October 17, 1989 – An earthquake registering 6.9 on the Richter scale interrupts game three of the World Series in San Francisco; 63 people die, and nearly 3,800 are injured.

THURSDAY 19

FRIDAY 20

SATURDAY 21

SUNDAY 22

OCTOBER 2023

MONDAY 23

TUESDAY 24

WEDNESDAY 25

October 29, 1929 – New York Stock Exchange prices collapse when stockholders sell 16 million shares. The crash ushers in the Great Depression.

THURSDAY 26

FRIDAY 27

SATURDAY 28

SUNDAY 29

NOVEMBER 2023

MONDAY 30

TUESDAY 31

Halloween

WEDNESDAY 1

November 4, 1922 – English archaeologist Howard Carter discovers the entrance to King Tutankhamun’s tomb in the Valley of the Kings, Egypt.

THURSDAY 2

6:00 PM - 7:00 PM - Southport
Middle School 7th/8th grade
band concert

FRIDAY 3

SATURDAY 4

SUNDAY 5

Standard time begins

NOVEMBER 2023

MONDAY 6

TUESDAY 7

Election Day

WEDNESDAY 8

November 11, 1918 – World War I comes to an end. Many countries recognize this day as Armistice Day; in the United States, it's known as Veterans Day.

THURSDAY 9

5:30 PM - 6:30 PM - Basketball
(Boys 7th) vs Indian Creek
Middle School (Away)
6:45 PM - 7:45 PM - Basketball
(Boys 8th) vs Indian Creek
Middle School (Away)

FRIDAY 10

SATURDAY 11

Veterans Day

SUNDAY 12

NOVEMBER 2023

MONDAY 13

TUESDAY 14

5:30 PM - 7:30 PM - Basketball
(Boys 7th) vs Raymond Park
Middle School (Away)

6:30 PM - 7:30 PM - Basketball
(Boys 8th) vs Raymond Park
Middle School (Away)

6:30 PM - 7:30 PM - Southport
Middle School 7th and 8th
Orchestra concert

WEDNESDAY 15

November 19, 1969 – Eighty thousand fans cheer as Brazilian soccer star Pelé scores his 1,000th professional goal in Rio de Janeiro.

THURSDAY 16

5:30 PM - 6:30 PM - Basketball
(Boys 8th) vs New Palestine
Junior High (Home)
5:30 PM - 7:30 PM - Basketball
(Boys 7th) vs New Palestine
Junior High (Home)

FRIDAY 17

SATURDAY 18

SUNDAY 19

NOVEMBER 2023

MONDAY 20

TUESDAY 21

WEDNESDAY 22

November 26, 1789 – George Washington issues his Thanksgiving Proclamation “to recommend to the people of the United States a day of public thanksgiving.”

THURSDAY 23

Thanksgiving

FRIDAY 24

SATURDAY 25

SUNDAY 26

NOVEMBER 2023

MONDAY 27

TUESDAY 28

5:30 PM - 6:30 PM - Basketball
(Boys 7th) vs Heritage
Christian Schools (Home)
6:30 PM - 7:30 PM - Basketball
(Boys 8th) vs Heritage
Christian Schools (Home)

WEDNESDAY 29

November 29, 1944 – The first open-heart surgery occurs at Johns Hopkins Hospital. It is known as the “Blue Baby Operation.”

THURSDAY 30

5:30 PM - 6:30 PM - Basketball
(Boys 7th) vs Franklin Central
Junior High (Away)

FRIDAY 1

SATURDAY 2

SUNDAY 3

8:00 AM - 9:00 AM - Wrestling
(Coed MS) Pre-season duals
(Home)

DECEMBER 2023

MONDAY 4

TUESDAY 5

WEDNESDAY 6

6:00 PM - 7:00 PM - Southport
Middle School 6th grade band
concert

December 7, 1941 – Two hundred Japanese aircraft attack the U.S. naval base at Pearl Harbor, Hawaii, pulling the United States into World War II.

THURSDAY 7

Hanukkah begins at sundown
5:30 PM - 6:30 PM - Basketball
(Boys 7th) vs Greenwood
Christian Academy (Home)
6:30 PM - 7:30 PM - Basketball
(Boys 8th) vs Greenwood
Christian Academy (Home)

FRIDAY 8

SATURDAY 9

SUNDAY 10

DECEMBER 2023

MONDAY 11

5:30 PM - 6:30 PM - Basketball
(Boys 7th) vs Perry Meridian
Middle School (Away)

TUESDAY 12

WEDNESDAY 13

December 17, 1903 – In the world's first powered flight, Orville and Wilbur Wright's biplane flies for 12 seconds near Kitty Hawk, North Carolina.

THURSDAY 14

5:30 PM - 6:30 PM - Basketball
(Boys 7th) vs Speedway Junior
High School (Home)
5:30 PM - 6:30 PM - Basketball
(Girls 7th) vs Paul Hadley
Middle School (Away)
6:45 PM - 7:45 PM - Basketball
(Boys 8th) vs Speedway Junior
High School (Home)
6:45 PM - 7:45 PM - Basketball
(Girls 8th) vs Paul Hadley
Middle School (Away)

FRIDAY 15

SATURDAY 16

SUNDAY 17

DECEMBER 2023

MONDAY 18

TUESDAY 19

5:30 PM - 7:30 PM - Basketball
(Boys 8th) vs Greenfield
Central Jr High School (Home)

5:45 PM - 6:45 PM - Basketball
(Boys 7th) vs Greenfield
Central Jr High School (Away)

WEDNESDAY 20

5:30 PM - 6:30 PM - Basketball
(Girls 7th) vs Raymond Park
Middle School (Away)

6:45 PM - 7:45 PM - Basketball
(Girls 8th) vs Raymond Park
Middle School (Away)

December 19, 1974 – The first personal computer goes on sale. The Altair 8800 is sold as a kit through *Popular Electronics* magazine.

THURSDAY 21

First day of winter

FRIDAY 22

SATURDAY 23

SUNDAY 24

DECEMBER 2023

MONDAY 25

Christmas

TUESDAY 26

Kwanzaa begins

WEDNESDAY 27

December 27, 1904 – *Peter Pan*, by playwright James Barrie, opens at the Duke of York's Theatre in London.

THURSDAY 28

FRIDAY 29

SATURDAY 30

SUNDAY 31

JANUARY 2024

MONDAY 1

New Year's Day

TUESDAY 2

WEDNESDAY 3

JANUARY 2024

MONDAY 8

5:30 PM - 6:30 PM - Basketball
(Girls 7th) vs Clark-Pleasant
Middle School (Away)

6:45 PM - 7:45 PM - Basketball
(Girls 8th) vs Clark-Pleasant
Middle School (Away)

TUESDAY 9

5:30 PM - 6:30 PM - Basketball
(Girls 7th) vs Franklin Central
Junior High (Away)

WEDNESDAY 10

5:30 PM - 6:30 PM - Basketball
(Boys 7th) vs Franklin
Community Middle School
(Away)

January 10, 1946 – Delegates from 51 nations meet in London for the first meeting of the United Nations General Assembly.

THURSDAY 11

5:45 PM - 6:45 PM - Basketball
(Girls 7th) vs Triton Central
Middle School (Away)
6:45 PM - 7:45 PM - Basketball
(Girls 8th) vs Triton Central
Middle School (Away)

FRIDAY 12

SATURDAY 13

8:00 AM - 9:00 AM - Wrestling
(Coed MS) Tri North
Invitational (Away)

SUNDAY 14

JANUARY 2024

MONDAY 15

Martin Luther King Jr. Day

TUESDAY 16

5:30 PM - 6:30 PM - Basketball
(Boys 7th) vs Beech Grove
Middle School (Away)

6:30 PM - 7:30 PM - Basketball
(Boys 8th) vs Beech Grove
Middle School (Away)

WEDNESDAY 17

5:30 PM - 6:30 PM - Basketball
(Girls 7th) vs Franklin
Community Middle School
(Away)

5:30 PM - 6:30 PM - Wrestling
(Coed MS) vs Beech Grove
Middle School (Home)

January 15, 1929 – Martin Luther King Jr., a Black civil rights leader, minister, advocate of nonviolence, and Nobel Peace Prize recipient, is born.

THURSDAY 18

5:30 PM - 6:30 PM - Basketball
(Girls 7th) vs Greenfield
Central Jr High School (Home)
6:00 PM - 7:00 PM - Basketball
(Girls 8th) vs Greenfield
Central Jr High School (Home)

FRIDAY 19

SATURDAY 20

8:00 AM - 9:00 AM - Wrestling
(Coed MS) vs Paul Hadley
Middle School (Away)

SUNDAY 21

11:00 AM - 6:00 PM - Southport
Middle School Band fundraiser

JANUARY 2024

MONDAY 22

- 5:30 PM - 6:30 PM - Basketball
(Boys 7th) vs Triton Central
Middle School (Away)
- 5:30 PM - 6:30 PM - Basketball
(Girls 7th) vs Speedway Junior
High School (Home)
- 6:30 PM - 7:30 PM - Basketball
(Girls 8th) vs Speedway Junior
High School (Home)
- 6:45 PM - 7:45 PM - Basketball
(Boys 8th) vs Triton Central
Middle School (Away)

TUESDAY 23

- 5:30 PM - 6:30 PM - Basketball
(Girls 7th) vs Greenwood
Christian Academy (Away)
- 6:45 PM - 7:45 PM - Basketball
(Girls 8th) vs Greenwood
Christian Academy (Away)

WEDNESDAY 24

- 5:30 PM - 6:30 PM - Basketball
(Boys 7th) vs Stonybrook
Middle School (Home)
- 5:30 PM - 6:30 PM - Wrestling
(Coed MS) vs Fall Creek
Valley Middle School (Away)
- 6:30 PM - 7:30 PM - Basketball
(Boys 8th) vs Stonybrook
Middle School (Home)

THURSDAY 25

5:30 PM - 6:30 PM - Basketball
(Girls 7th) vs Heritage
Christian Schools (Home)
5:30 PM - 6:30 PM - Wrestling
(Coed MS) vs Franklin Central
Junior High (Away)
6:30 PM - 7:30 PM - Basketball
(Girls 8th) vs Heritage
Christian Schools (Home)

FRIDAY 26

SATURDAY 27

SUNDAY 28

JANUARY 2024

MONDAY 29

5:30 PM - 6:30 PM - Basketball
(Girls 7th) vs Columbus
Central Middle School (Home)

TUESDAY 30

WEDNESDAY 31

January 30, 1948 – A Hindu fanatic assassinates Mohandas Gandhi, the political and spiritual leader of the Indian independence movement.

THURSDAY 1

5:30 PM - 6:30 PM - Wrestling
(Coed MS) vs Belzer Middle
School (Away)
6:00 PM - 7:00 PM - Basketball
(Girls 7th) vs Perry Meridian
Middle School (Home)

FRIDAY 2

Groundhog Day

SATURDAY 3

SUNDAY 4

FEBRUARY 2024

MONDAY 5

6:00 PM - 7:00 PM - Swimming
(Coed MS) vs Perry Meridian
Middle School (Home)

TUESDAY 6

5:30 PM - 6:30 PM - Basketball
(Girls 7th) vs Beech Grove
Middle School (Away)

6:30 PM - 7:30 PM - Basketball
(Girls 8th) vs Beech Grove
Middle School (Away)

WEDNESDAY 7

February 7, 1964 – The Beatles, a British rock band, arrive in the United States for the first time.

THURSDAY 8

5:30 PM - 6:30 PM - Basketball
(Girls 7th) vs Morristown Jr-Sr
High School (Home)

FRIDAY 9

SATURDAY 10

Lunar New Year

SUNDAY 11

FEBRUARY 2024

MONDAY 12

Lincoln's Birthday
6:00 PM - 7:00 PM - Swimming
(Coed MS) vs Clark-Pleasant
Middle School (Away)

TUESDAY 13

5:30 PM - 6:30 PM - Wrestling
(Coed MS) vs New Palestine
Junior High (Home)

WEDNESDAY 14

Ash Wednesday
Valentine's Day

February 15, 1965 – Canada officially adopts the red maple leaf flag, one of the world's most recognizable national emblems.

THURSDAY 15

FRIDAY 16

SATURDAY 17

SUNDAY 18

FEBRUARY 2024

MONDAY 19

Presidents' Day

TUESDAY 20

5:30 PM - 6:30 PM - Wrestling
(Coed MS) vs Lynhurst 7th &
8th Grade Center (Home)

WEDNESDAY 21

February 24, 1786 – Wilhelm Grimm, the younger of the Brothers Grimm, is born in Hanau, Germany. Their folktales are later published as *Grimms' Fairy Tales*.

THURSDAY 22

Washington's Birthday
5:30 PM - 6:30 PM - Wrestling
(Coed MS) vs Perry Meridian
Middle School (Away)

FRIDAY 23

SATURDAY 24

9:00 AM - 10:00 AM - Wrestling
(Coed MS) vs Hamilton
Heights Middle School (Away)

SUNDAY 25

FEBRUARY 2024

MONDAY 26

TUESDAY 27

WEDNESDAY 28

5:30 PM - 6:30 PM - Wrestling
(Coed MS) vs Triton Central
Middle School (Away)

February 26, 1919 – Grand Canyon National Park is established, covering 1.2 million acres. A gorge of the Colorado River, it is considered one of the world's most spectacular natural phenomena.

THURSDAY 29

FRIDAY 1

SATURDAY 2

8:00 AM - 9:00 AM - Wrestling
(Coed MS) Decatur Invitational
(Away)

SUNDAY 3

MARCH 2024

MONDAY 4

TUESDAY 5

WEDNESDAY 6

March 7, 1876 – Alexander Graham Bell receives a patent for an invention he calls the telephone.

THURSDAY 7

6:30 PM - 7:30 PM - Southport Middle School 7th and 8th Orchestra concert

FRIDAY 8

SATURDAY 9

SUNDAY 10

*Daylight saving time begins
Ramadan begins at sundown*

MARCH 2024

MONDAY 11

TUESDAY 12

WEDNESDAY 13

March 11, 2009 – Toyota Motor Co. sells its millionth hybrid electric vehicle in the United States. The Prius model is the most popular.

THURSDAY 14

FRIDAY 15

SATURDAY 16

SUNDAY 17

St. Patrick's Day

MARCH 2024

MONDAY 18

TUESDAY 19

First day of spring

WEDNESDAY 20

March 20, 1916 – Albert Einstein publishes his theory of general relativity.

THURSDAY 21

FRIDAY 22

SATURDAY 23

SUNDAY 24

Palm Sunday

MARCH 2024

MONDAY 25

TUESDAY 26

WEDNESDAY 27

March 26, 1953 – U.S. medical researcher Jonas Salk announces that his tests of a vaccine against the virus that causes polio have been successful.

THURSDAY 28

FRIDAY 29

Good Friday

SATURDAY 30

SUNDAY 31

Easter

APRIL 2024

MONDAY 1

April Fools' Day

TUESDAY 2

WEDNESDAY 3

April 6, 648 B.C. – Ancient Greeks record a solar eclipse for the first time. Earlier eclipses were recorded in China and Babylon.

THURSDAY 4

Laylat al-Qadr begins at sundown

FRIDAY 5

6:00 PM - 7:00 PM - Southport
Middle School ISSMA band
contest

SATURDAY 6

6:00 PM - 7:00 PM - Southport
Middle School ISSMA band
contest

SUNDAY 7

APRIL 2024

MONDAY 8

5:30 PM - 6:30 PM - Softball (Girls Varsity) vs Beech Grove Middle School (Home)

TUESDAY 9

Eid al-Fitr begins at sundown

5:30 PM - 6:30 PM - Baseball (Boys RED) vs Plainfield Community Middle School (Away)

5:30 PM - 6:30 PM - Softball (Girls Varsity) vs Plainfield Community Middle School (Away)

5:30 PM - 6:30 PM - Softball (JV) vs Heritage Christian Schools (Home)

5:30 PM - 6:30 PM - Track (Boys MS) vs Beech Grove Middle School, Greenwood Middle School (Home)

5:30 PM - 6:30 PM - Track (Girls MS) vs Beech Grove Middle School, Greenwood Middle School (Home)

WEDNESDAY 10

4:30 PM - 5:30 PM - Golf (Boys MS) vs Franklin Central Junior High (Home)

5:30 PM - 6:30 PM - Baseball (Boys WHITE) vs Belzer Middle School (Home)

5:30 PM - 6:30 PM - Softball (Girls Varsity) vs Fall Creek Valley Middle School (Away)

April 11, 1970 – Apollo 13 launches from Cape Kennedy (now Cape Canaveral), Florida; the mission is aborted after an oxygen tank explodes en route to the moon.

THURSDAY 11

5:30 PM - 6:30 PM - Baseball
(Boys RED) vs New Palestine
Junior High (Away)
5:30 PM - 6:30 PM - Baseball
(Boys WHITE) vs New
Palestine Junior High (Home)
5:30 PM - 6:30 PM - Track (Boys
MS) vs Center Grove Middle
School Central (Away)
5:30 PM - 6:30 PM - Track (Girls
MS) vs Center Grove Middle
School North (Away)

FRIDAY 12

SATURDAY 13

SUNDAY 14

APRIL 2024

MONDAY 15

- 5:30 PM - 6:30 PM - Baseball (Boys RED) vs Shelbyville Middle School (Away)
- 5:30 PM - 6:30 PM - Baseball (Boys WHITE) vs Plainfield Community Middle School (Home)
- 5:30 PM - 6:30 PM - Softball (Girls Varsity) vs Speedway Junior High School (Away)

TUESDAY 16

- 5:00 PM - 6:00 PM - Golf (Boys MS) vs Decatur Middle School (Away)
- 5:30 PM - 6:30 PM - Baseball (Boys RED) vs Perry Meridian Middle School (Away)
- 5:30 PM - 6:30 PM - Softball (Girls Varsity) vs Belzer Middle School (Away)
- 5:30 PM - 6:30 PM - Softball (JV) vs Fall Creek Valley Middle School (Home)
- 5:30 PM - 6:30 PM - Tennis (Girls MS) vs Franklin Central Junior High (Home)

WEDNESDAY 17

April 15, 1912 – The “unsinkable” luxury liner *Titanic* hits an iceberg and sinks on its maiden voyage from Southampton, England, to New York City; more than 1,500 of its 2,200 passengers perish.

THURSDAY 18

5:30 PM - 6:30 PM - Softball (Girls Varsity) vs Franklin Central Junior High (Home)
5:30 PM - 6:30 PM - Softball (JV) vs Franklin Central Junior High (Away)
5:30 PM - 6:30 PM - Tennis (Girls MS) vs New Augusta Public Academy (Home)
5:30 PM - 6:30 PM - Track (Boys MS) vs Heritage Christian Schools (Home)
5:30 PM - 6:30 PM - Track (Girls MS) vs Heritage Christian Schools (Home)

FRIDAY 19

SATURDAY 20

SUNDAY 21

APRIL 2024

MONDAY 22

Earth Day

Passover begins at sundown

- 5:15 PM - 6:15 PM - Softball (JV)
vs Beech Grove Middle School
(Away)
- 5:30 PM - 6:30 PM - Baseball (Boys
RED) vs Lynhurst 7th & 8th Grade
Center (Away)
- 5:30 PM - 6:30 PM - Softball (Girls
Varsity) vs Lynhurst 7th & 8th
Grade Center (Home)
- 5:30 PM - 6:30 PM - Track (Boys MS)
vs Decatur Middle School, Franklin
Central Junior High, Raymond
Park Middle School (Away)
- 5:30 PM - 6:30 PM - Track (Girls MS)
vs Decatur Middle School, Franklin
Central Junior High, Raymond
Park Middle School (Away)

TUESDAY 23

- 5:30 PM - 6:30 PM - Softball (JV)
vs Perry Meridian Middle
School (Away)
- 5:30 PM - 6:30 PM - Tennis (Girls
MS) vs Perry Meridian Middle
School (Home)
- 5:30 PM - 7:30 PM - Volleyball (7th
Boys) vs Paul Hadley Middle
School (Home)
- 6:30 PM - 8:30 PM - Volleyball
(8th Boys) vs Perry Meridian
Middle School (Home)

WEDNESDAY 24

- 5:30 PM - 6:30 PM - Tennis (Girls
MS) vs Fall Creek Valley
Middle School (Home)

April 22, 1970 – People in the United States celebrate the first Earth Day to increase public awareness of the world’s environmental problems.

THURSDAY 25

5:30 PM - 6:30 PM - Baseball
(Boys RED) vs Franklin
Central Junior High (Home)
5:30 PM - 6:30 PM - Baseball
(Boys WHITE) vs Franklin
Central Junior High (Away)
5:30 PM - 6:30 PM - Softball (JV)
vs Morristown Jr-Sr High
School (Home)
5:30 PM - 6:30 PM - Track (Boys
MS) vs Perry Meridian Middle
School (Home)
5:30 PM - 6:30 PM - Track (Girls
MS) vs Perry Meridian Middle
School (Home)

FRIDAY 26

SATURDAY 27

SUNDAY 28

MAY 2024

MONDAY 29

TUESDAY 30

- 5:30 PM - 6:30 PM - Baseball (Boys RED) vs Paul Hadley Middle School (Home)
- 5:30 PM - 6:30 PM - Baseball (Boys WHITE) vs Speedway Junior High School (Away)
- 5:30 PM - 6:30 PM - Softball (Girls Varsity) vs New Augusta Public Academy (Away)
- 5:30 PM - 6:30 PM - Tennis (Girls MS) vs Decatur Middle School (Away)
- 5:30 PM - 6:30 PM - Track (Boys MS) vs Stonybrook Middle School, Creston Intermediate & Middle School (Home)
- 5:30 PM - 6:30 PM - Track (Girls MS) vs Stonybrook Middle School, Creston Intermediate & Middle School (Home)
- 5:30 PM - 7:30 PM - Volleyball (7th Boys) vs Franklin Central Junior High (Home)
- 6:30 PM - 8:30 PM - Volleyball (8th Boys) vs Franklin Central Junior High (Home)

WEDNESDAY 1

- 5:15 PM - 6:15 PM - Tennis (Girls MS) vs Indian Creek Middle School (Away)
- 5:30 PM - 6:30 PM - Baseball (Boys RED) vs Decatur Middle School (Away)
- 5:30 PM - 6:30 PM - Baseball (Boys WHITE) vs Decatur Middle School (Home)
- 5:30 PM - 6:30 PM - Softball (Girls Varsity) vs Decatur Middle School (Away)
- 5:30 PM - 6:30 PM - Softball (JV) vs Decatur Middle School (Home)

April 29, 1429 – Joan of Arc leads a French force to end the English siege of the city of Orléans, France. She is captured and killed in 1431.

THURSDAY 2

5:30 PM - 6:30 PM - Baseball (Boys WHITE) vs Beech Grove Middle School (Away)
5:30 PM - 6:30 PM - Tennis (Girls MS) vs Creston Intermediate & Middle School (Away)
5:30 PM - 6:30 PM - Track (Boys MS) vs Belzer Middle School (Away)
5:30 PM - 6:30 PM - Track (Girls MS) vs Belzer Middle School (Away)
5:30 PM - 7:30 PM - Volleyball (7th Boys) vs Eastwood Middle School (Away)
6:30 PM - 8:30 PM - Volleyball (8th Boys) vs Eastwood Middle School (Away)

FRIDAY 3

SATURDAY 4

SUNDAY 5

Cinco de Mayo

MAY 2024

MONDAY 6

- 5:30 PM - 6:30 PM - Baseball (Boys RED) vs Perry Meridian Middle School (Home)
- 5:30 PM - 6:30 PM - Baseball (Boys WHITE) vs Fall Creek Valley Middle School (Away)
- 5:30 PM - 6:30 PM - Softball (Girls Varsity) vs Perry Meridian Middle School (Away)
- 5:30 PM - 6:30 PM - Tennis (Girls MS) vs New Palestine Junior High (Away)
- 5:30 PM - 6:30 PM - Track (Boys MS) vs New Palestine Junior High, Shelbyville Middle School (Away)
- 5:30 PM - 6:30 PM - Track (Girls MS) vs New Palestine Junior High, Shelbyville Middle School (Away)

TUESDAY 7

- 5:30 PM - 6:30 PM - Baseball (Boys RED) vs Fall Creek Valley Middle School (Away)
- 5:30 PM - 6:30 PM - Baseball (Boys WHITE) vs Paul Hadley Middle School (Home)
- 5:30 PM - 6:30 PM - Softball (Girls Varsity) vs Paul Hadley Middle School (Home)
- 5:30 PM - 6:30 PM - Softball (JV) vs Shelbyville Middle School (Away)
- 5:30 PM - 6:30 PM - Tennis (Girls MS) vs Lynhurst 7th & 8th Grade Center (Home)

WEDNESDAY 8

May 6, 1889 – The Eiffel Tower opens to the public at the Universal Exposition in Paris. For 41 years, the tower is the world’s tallest building.

THURSDAY 9

5:30 PM - 6:30 PM - Baseball
(Boys WHITE) vs Heritage
Christian Schools (Away)
5:30 PM - 6:30 PM - Softball (Girls
Varsity) vs New Palestine
Junior High (Home)
5:30 PM - 6:30 PM - Softball (JV)
vs New Palestine Junior High
(Away)
5:30 PM - 6:30 PM - Tennis (Girls
MS) vs Raymond Park Middle
School (Away)
5:30 PM - 7:30 PM - Volleyball
(7th Boys) vs Franklin Central
Junior High (Away)
6:30 PM - 8:30 PM - Volleyball
(8th Boys) vs Franklin Central
Junior High (Away)

FRIDAY 10

SATURDAY 11

SUNDAY 12

Mother's Day

MAY 2024

MONDAY 13

- 5:30 PM - 6:30 PM - Baseball (Boys WHITE) vs Perry Meridian Middle School (Home)
- 5:30 PM - 6:30 PM - Tennis (Girls MS) vs Shelbyville Middle School (Home)
- 5:30 PM - 6:30 PM - Track (Boys MS) County prelims (Home)
- 5:30 PM - 6:30 PM - Track (Girls MS) County prelims (Home)
- 5:30 PM - 7:30 PM - Volleyball (7th Boys) vs Perry Meridian Middle School (Away)
- 6:30 PM - 8:30 PM - Volleyball (8th Boys) vs Perry Meridian Middle School (Away)

TUESDAY 14

- 5:30 PM - 6:30 PM - Baseball (Boys RED) vs Beech Grove Middle School (Home)
- 5:30 PM - 6:30 PM - Tennis (Girls MS) vs Beech Grove Middle School (Home)
- 6:30 PM - 7:30 PM - Southport Middle School Band concert @SHS

WEDNESDAY 15

- 5:30 PM - 6:30 PM - Baseball (Boys RED) vs New Augusta Public Academy (Away)
- 5:30 PM - 6:30 PM - Softball (JV) vs New Augusta Public Academy (Away)

May 15, 1940 – In San Bernardino, California, brothers Maurice (“Mac”) and Richard McDonald open a drive-in restaurant that gives rise to the fast-food chain McDonald’s.

THURSDAY 16

6:00 PM - 7:00 PM - Southport
Middle School 6th gradeband
concert
6:00 PM - 7:00 PM - Southport
Middle School 7th band
concert

FRIDAY 17

TBA - Track (Boys MS) county
finals (Away)

SATURDAY 18

SUNDAY 19

MAY 2024

MONDAY 20

6:30 PM - 7:30 PM - Southport
Middle School 7th and 8th
Orchestra concert

TUESDAY 21

WEDNESDAY 22

May 21, 1932 – Amelia Earhart becomes the first woman to fly solo across the Atlantic Ocean.

THURSDAY 23

FRIDAY 24

SATURDAY 25

SUNDAY 26

JUNE 2024

★ GOALS

MONDAY	TUESDAY	WEDNESDAY	THURSDAY
27	28	29	30
3	4	5	6
10	11	12	13
17	18	19 <i>Juneteenth</i>	20 <i>First day of summer</i>
24	25	26	27

FRIDAY	SATURDAY	SUNDAY	NOTES
31	1	2	<hr/> <hr/> <hr/> <hr/> <hr/> <hr/> <hr/> <hr/>
7	8	9	<hr/> <hr/> <hr/> <hr/> <hr/> <hr/> <hr/> <hr/>
<i>Flag Day</i> 14	15	<i>Eid al-Adha begins at sundown</i> <i>Father's Day</i> 16	<hr/> <hr/> <hr/> <hr/> <hr/> <hr/> <hr/> <hr/>
21	22	23	<hr/> <hr/> <hr/> <hr/> <hr/> <hr/> <hr/> <hr/>
28	29	30	<hr/> <hr/> <hr/> <hr/> <hr/> <hr/> <hr/> <hr/>

LANGUAGE ARTS *parts of speech*

NOUN	A WORD THAT NAMES A PERSON, PLACE, THING, QUALITY, ACT, OR FEELING.
-------------	---

Common nouns are general and do not refer to a specific person, location, or object.

→ *Examples:* man, city, tonight, honesty, happiness

Proper nouns are capitalized and refer to a particular person, place, or thing.

→ *Examples:* Reggie, Market Square Arena, Saturday

PRONOUN	A WORD THAT TAKES THE PLACE OF A NOUN.
----------------	--

Nominative Case Pronouns replace the subject of a sentence or clause.

→ *Examples:* *She* took the bus to visit Aunt Jane.

We are looking forward to visiting Oregon.

Objective Case Pronouns receive a verb's action or follow a preposition.

→ *Examples:* Please give *me* the papers.

Timothy's outstanding service earned *him* the award.

Possessive Case Pronouns show ownership or possession.

→ *Examples:* The cougar escaped from *its* cage.

Their car slid off the icy road.

VERB	A WORD THAT EXPRESSES ACTION OR A STATE OF BEING. IT ALSO INDICATES THE TIME OF ACTION OR STATE OF BEING. A VERB HAS DIFFERENT FORMS DEPENDING ON ITS NUMBER, PERSON, VOICE, TENSE, AND MOOD.
-------------	---

Number indicates whether a verb is singular or plural. The verb and its subject must agree in number.

→ *Examples:* One dog barks. Two dogs bark.

Person indicates whether the subject of the verb is 1st, 2nd, or 3rd person and whether the subject is singular or plural. Verbs usually have a different form only in *third person singular of the present tense*.

→ <i>Examples:</i>	<i>Singular</i>	<i>Plural</i>
1 st Person:	I stop.	We stop.
2 nd Person:	You stop.	You stop.
3 rd Person:	He/She/It stops.	They stop.

Voice indicates whether the subject is the doer or the receiver of the action verb.

→ *Examples:* Cathy wrote the letter. (active voice)

The letter was written by Cathy. (passive voice)

Tense indicates when the action or state of being is taking place.

→ *Examples:* *We need* the information now. (present)

Reggie *shot* the ball. (past)

You *will enjoy* the school play. (future)

ADVERB	A WORD THAT DESCRIBES OR MODIFIES A VERB, AN ADJECTIVE, OR ANOTHER ADVERB. AN ADVERB TELLS HOW, WHEN, WHERE, WHY, HOW OFTEN, AND HOW MUCH.
---------------	--

→ *Examples:* The ball rolled *slowly* around the rim.

Soccer scores are reported *daily* in the newspaper.

ADJECTIVE	A WORD THAT DESCRIBES OR MODIFIES NOUNS AND PRONOUNS. ADJECTIVES SPECIFY COLOR, SIZE, NUMBER, AND THE LIKE.
------------------	---

→ *Examples:* red, large, three, gigantic, miniature

Adjectives have three forms: **positive**, **comparative**, and **superlative**.

The **positive** form describes a noun or pronoun without comparing it to anything else.

→ *Example:* My apple pie is *good*.

The **comparative** form compares two things.

→ *Example:* Aunt Betty's apple pie is *better* than mine.

The **superlative** form compares three or more things.

Example: Mom's apple pie is the *best* of all!

PREPOSITION	A WORD (OR GROUP OF WORDS) THAT SHOWS HOW A NOUN OR PRONOUN RELATES TO ANOTHER WORD IN A SENTENCE.
--------------------	--

→ *Examples:* The man walked *into* the gym.

The horse leaped *over* the fence.

Their team won the meet *in spite of* several players being injured.

CONJUNCTION	A WORD THAT CONNECTS INDIVIDUAL WORDS OR GROUPS OF WORDS.
--------------------	---

Coordinating conjunctions connect a word to a word, a clause to a clause, or a phrase to a phrase. The sentence elements joined by a coordinating conjunction must be equal. Common coordinating conjunctions are: *and, but, or, nor, for, yet, so*.

Coordinating conjunctions used in pairs are called **correlative conjunctions**. Common correlative conjunctions are: *either, or; neither, nor; not only, but also; both, and; whether, or*.

→ *Examples:* *Both* raccoons *and* squirrels frequently invade our bird feeders.

Neither Mary Ann *nor* Julie will be able to go with you.

Subordinating conjunctions connect and show the relationship between two clauses that are not equally important. Common subordinate conjunctions are: *until, unless, since, where, before, as, if, when, although, after, because, while, as long as, as if, though, whereas*.

→ *Examples:* *Until* you decide to study, your grades won't improve.

If I hadn't already made plans, I would have enjoyed going to the mall with you.

INTERJECTION	A WORD THAT IS USED IN A SENTENCE TO COMMUNICATE STRONG EMOTION OR SURPRISE. PUNCTUATION IS USED TO SEPARATE AN INTERJECTION FROM THE REST OF THE SENTENCE.
---------------------	---

→ *Examples:* *Hooray!* We finally scored a touchdown.

Oh, no! I forgot the picnic basket.

Yes! Her gymnastic routine was perfect.

Ah, we finally get to stop and rest.

LANGUAGE ARTS *capitalization & plurals*

CAPITALIZATION THE FOLLOWING CHART PROVIDES A QUICK OVERVIEW OF CAPITALIZATION RULES.

All proper nouns → Shannon O'Connor, Orlando, Bill of Rights
All proper adjectives → Kraft cheese, Bounty paper towels, Phillips screwdriver
The first word in every sentence → Her dress is stunning.
Races, languages, nationalities → Asian, French, African-American
Nouns/Pronouns that refer to a supreme being → God, Allah, Yahweh
Days of the week → Sunday, Monday, Tuesday
Formal epithets → Ivan the Terrible
Bodies of water → Amazon River, Lake Huron, Wea Creek
Cities, towns → Houston, Lafayette, Dearborn
Counties → Tippecanoe, Cork
Countries → U.S.A, Mexico, Canada
Continents → Africa, North America
Landforms → Mojave Desert, the Appalachians
Holidays and holy days → Veterans Day, Christmas, Yom Kippur
Months → January, February
Official documents → Emancipation Proclamation
Official titles → President Obama, Mayor Bradley
Periods and events in history → Middle Ages, Renaissance
Planets, heavenly bodies → Mars, Jupiter, Milky Way
Public areas → Yellowstone National Park
Sections of a country or continent → the Northwest, the Middle East
Special events → Battle of Lexington
Streets, roads, highways → Rodeo Drive, Route 66, Interstate 65
Trade names → Honda Accord, Kellogg's Corn Flakes

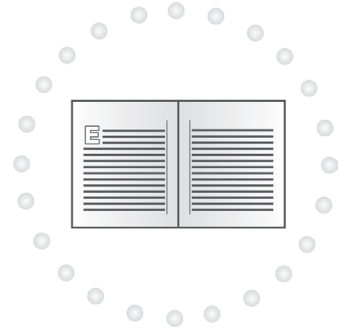

PLURALS THE FOLLOWING CHART PROVIDES A QUICK OVERVIEW OF PLURALIZATION RULES.

The plurals of most nouns are formed by adding *s* to the singular.
→ *Examples:* pie = pies | desk = desks | machine = machines

The plural forms of nouns ending in *s*, *sh*, *x*, *z* and *ch* are made by adding *es* to the singular.
→ *Examples:* bus = buses | dish = dishes | fox = foxes | buzz = buzzes | church = churches

The plurals of common nouns that end in *y* preceded by a consonant are formed by changing the *y* to *i* and adding *es*.
→ *Examples:* fly = flies | copy = copies

The plurals of words that end in *y* preceded by a vowel are formed by adding only *s*.
→ *Examples:* holiday = holidays | monkey = monkeys

The plurals of words ending in *o* preceded by a vowel are formed by adding *s*.
→ *Examples:* studio = studios | rodeo = rodeos

The plurals of words ending in *o* preceded by a consonant are formed by adding *s* or *es*.
→ *Examples:* hero = heroes | banjo = banjos | tomato = tomatoes | piano = pianos

The plurals of nouns ending in *f* or *fe* are formed in one of two ways:
{1} If the *f* sound is still heard in the plural form, simply add *s*.
→ *Examples:* roof = roofs | chief = chiefs
{2} If the final sound in the plural is a *ve* sound, change the *f* to *ve* and add *s*.
→ *Examples:* wife = wives | knife = knives

Foreign words and some English words form the plural by taking on an irregular spelling.
→ *Examples:* crisis = crises | criterion = criteria | goose = geese | ox = oxen

The plurals of symbols, letters, and figures are formed by adding an *s*.
→ *Examples:* 5 = 5s

The plural of nouns that end in *ful* are formed by adding *s* at the end of the word.
→ *Examples:* handful = handfuls | pailful = pailfuls | tankful = tankfuls

LANGUAGE ARTS *sentence structure & spelling rules*

SENTENCE STRUCTURE

A **complete sentence** must express a complete thought and must have a subject and a verb.

→ *Example:* He lost the game.

A **sentence fragment** results from a *missing* subject, verb or complete thought.

→ *Example:* Because he was lost.



THERE ARE FOUR TYPES OF SENTENCES: SIMPLE, COMPOUND, COMPLEX, OR COMPOUND-COMPLEX

1

A **simple sentence** consists of one main clause. It expresses one main thought and has one subject and one verb. A simple sentence may contain a compound subject, a compound verb, or both.

→ *Examples:* We enjoyed the concert.

Amy and Scott were married yesterday. (compound subject: Amy and Scott)

Ben is leaving work and going home. (compound verb: leaving and going)

2

A **compound sentence** contains two or more main clauses (in italics) connected by a conjunction, a semicolon, or a comma with a conjunction.

→ *Examples:* *Collecting fossils is fun*, but *I think identifying fossils is difficult*. (conjunction)

Andy's suit looks new; *it just got back from the cleaners*. (semicolon)

Erin came home for Easter, and *Courtney went to Florida*. (comma/conjunction)

3

A **complex sentence** has one main clause (in italics) and one or more subordinate clauses (underlined).

→ *Examples:* *Dad says* that good grades are the result of diligent studying. (main clause, one independent clause)

Diligent studying is difficult, because I have to work several hours before I can start studying. (main clause, two dependent clauses)

4

A **compound-complex sentence** has two or more main clauses (in italics) and one or more subordinate clauses (underlined).

→ *Examples:* Because the school bus broke down, *the team rode in a van*, and *the cheerleaders rode in cars*.

Unless my eyes are deceiving me, *Kristi is on that runaway horse*, and *Dale is behind her*.

SPELLING RULES

Write *i* before *e* except after *c*, or when sounded like *a* as in *weigh* and *eight*.

→ *Exceptions:* seize, weird, either, leisure, neither

When the *ie/ei* combination is not pronounced *ee*, it is usually spelled *ei*.

→ *Examples:* reign, weigh, neighbor

→ *Exceptions:* friend, view, mischief, fiery

When a multi-syllable word ends in a consonant preceded by one vowel, the accent is on the last syllable and the suffix begins with a vowel — the same rule holds true when you double the final consonant.

→ *Examples:* prefer = preferred | allot = allotted | control = controlling

If a word ends with a silent *e*, drop the *e* before adding a suffix that begins with a vowel.

→ *Examples:* use = using | like = liking | state = stating | love = loving

When the suffix begins with a consonant, do not drop the *e*.

→ *Examples:* use = useful | state = statement | nine = ninety

→ *Exceptions:* argument, judgment, truly, ninth

When *y* is the last letter in a word and the *y* is preceded by a consonant, change the *y* to *i* before adding any suffix except those beginning with *i*.

→ *Examples:* lady = ladies | try = tries | happy = happiness | ply = pliable | fly = flying

LANGUAGE ARTS *punctuation*

PERIOD ●

Use: to end a sentence that makes a statement or that gives a command not used as an exclamation.

→ *Example:* Go to your room, and do not come out until dinner.

Use: after an initial or an abbreviation.

→ *Examples:* Mary J. Jones, Mr., Mrs., Ms.

COMMA ,

Use: to separate words or groups of words in a series.

→ *Example:* I used *worms, minnows, larva, bread balls, and bacon* for bait.

Note: Some stylebooks and teachers require a comma before “and” in a series.

→ *Example:* He *ran, jumped, and yelled.*

Use: to separate an explanatory phrase from the rest of the sentence.

→ *Example:* Escargots, *or snails,* are a delicacy that I relish.

Use: to distinguish items in an address and in a date.

→ *Example:* John Doe, 290 Main St. Midtown, IN 48105 September 20, 1960

Use: to separate a title or an initial that follows a name.

→ *Example:* Joseph Jones, Ph.D.

QUESTION MARK ?

Use: at the end of a direct or indirect question.

→ *Example:* Did your relatives invite you to visit them this summer?

Use: to punctuate a short question within parentheses.

→ *Example:* I am leaving tomorrow (is that possible?) to visit my cousins in France.

APOSTROPHE ’

Use: to show that one or more letters or numbers have been left out of a word to form a contraction.

→ *Examples:* do not = don’t | I have = I’ve

Use: followed by an *s* is the possessive form of singular nouns.

→ *Example:* I clearly saw this young *man’s* car run that stop sign.

Use: possessive form of plural nouns ending in *s* is usually made by adding just an apostrophe. An apostrophe and *s* must be added to nouns not ending in *s*.

→ *Example:* bosses = bosses’, children’s

COLON :

Use: after words introducing a list, quotation, question, or example.

→ *Example:* Sarah dropped her book bag and out spilled everything: books, pens, pencils, homework, and makeup.

SEMICOLON ;

Use: to join compound sentences that are not connected with a conjunction.

→ *Example:* It’s elementary, my dear Watson; the butler is clearly responsible.

Use: to separate groups of words.

→ *Example:* I packed a toothbrush, deodorant, and perfume; jeans, a raincoat, and sweatshirts; and boots and tennis shoes.

QUOTATION MARKS “ ”

Use: to frame direct quotations in a sentence. Only the exact words quoted are placed within the quotation marks.

→ *Example:* “I don’t know,” she said, “if I will be able to afford the vacation.”

Use: to distinguish a word that is being discussed.

→ *Example:* Mr. Jones suggested I replace the word “always” with “often” in my theme.

Use: to indicate that a word is slang.

→ *Example:* Julie only bought that outfit to show that she’s “with it.”

Use: to punctuate titles of poems, short stories, songs, lectures, course titles, chapters of books, and articles found in magazines, newspapers, and encyclopedias.

→ *Examples:* “You Are My Sunshine,” “Violence in Our Society,” “The Road Not Taken”

SINGLE QUOTATION MARK ‘ ’

Use: to punctuate a quotation within a quotation.

→ *Example:* “My favorite song is ‘I’ve Been Working on the Railroad,’” answered little Joey.

EXCLAMATION MARK !

Use: to express strong feeling.

→ *Example:* Help! Help!

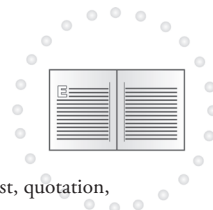

LANGUAGE ARTS *common prefixes & suffixes*

COMMON PREFIXES	A PREFIX IS A SYLLABLE ADDED TO THE BEGINNING OF A WORD TO CHANGE ITS MEANING
------------------------	--

Prefix	Meaning	Examples
auto-	self	automobile, autopilot
bi-	two or twice	bicycle, biannual, biweekly
com-	with	compare, communicate, company
con-	with	conference, concert, confide
dis-	do the opposite of	disappear, dislike, distrust
en-	to make	ensure, enlarge, enable
extra-	beyond	extraordinary, extrasensory
il-	not	illegal, illogical, illiterate
im-	not or within	impossible, immature, impatient
in-	not or within	insecure, incomplete, indoors, ingrown
inter-	between	international, interact, intersection
ir-	not	irresponsible, irregular
mid-	middle	midnight, midstream, midway
mis-	wrong	mistake, misguide, misunderstood
non-	not or without	nonsense, nonfat, nonfiction
post-	after	postgraduate, postwar
pre-	before	prehistoric, precaution, preschool
re-	back or again	return, rewrite, recycle, react
sub-	below	submarine, subzero, subtitle
super-	above, outside	supernatural, supermarket, superpower
trans-	across, over	transplant, transcontinental, transport
un-	not	unsafe, unusual, unsure



COMMON SUFFIXES	A SUFFIX IS A SYLLABLE ADDED TO THE END OF A WORD TO CHANGE ITS MEANING. IN MOST CASES, WHEN ADDING A SUFFIX THAT STARTS WITH A VOWEL, DROP THE FINAL E OF THE ROOT WORD. FOR EXAMPLE, NERVE BECOMES NERVOUS. ALSO, CHANGE A FINAL Y IN THE ROOT WORD TO AN I BEFORE ADDING A SUFFIX, EXCEPT -ING.
------------------------	---

Suffix	Meaning	Examples
-able	able to be	payable, movable, portable
-al	of, like, or suitable for	logical, natural, comical
-an	relating to, belonging to, or living in	American, European, librarian
-ance	the condition or state of being	performance, allowance
-ant	a person or thing that does something	contestant, peasant, servant
-ative	having the nature of or relating to	imaginative, talkative, decorative
-ent	characterized by	different, reverent, independent
-ful	full of	thoughtful, beautiful
-ian	relating to, belonging to, or living in	musician, magician
-ity	quality or degree	activity, fatality, popularity
-ive	have or tend to be	active, attractive, impressive
-less	without or lacking	homeless, thoughtless
-ment	act of	payment, employment, achievement
-ness	state of	happiness, thoughtfulness
-or	person or thing that does something	actor, accelerator
-ous	characterized by	nervous, courageous, famous
-ship	quality of or having the office of	friendship, leadership, companionship
-ward	in the direction of	backward, homeward, westward

Figurative Language:

When someone says, "It's raining cats and dogs," does he/she **literally** mean that cats and dogs are falling from the sky? No! He/she means it is raining hard. That's **figurative** language. If I say, "I'm so hungry I could eat a horse," I don't really mean that I could eat a horse, do I? I just mean that I am really hungry, right? Any time an author doesn't **literally** mean what he/she writes, we have **figurative** language. Some of the most common types of **figurative** language are: alliteration, hyperbole, idioms, imagery, metaphor, onomatopoeia, personification, and simile.

Alliteration is repeated consonant sounds occurring at the beginning of words or within words.

EXAMPLE: "Peter Piper picked a peck of pickled peppers," or "Boisterous bumblebees whizzed by."

Hyperbole is an exaggerated statement used to heighten effect. It is not used to mislead the reader but to emphasize a point. EXAMPLE: "I've read that book a million times."

Idioms are common figures of speech that will be different from culture to culture. Two American idioms were used in the introductory paragraph. EXAMPLE: "You can't teach an old dog new tricks."

Imagery is language that appeals to the five senses (taste, touch, sound, sight, smell). EXAMPLE: "The scent of fresh cinnamon wafted through the air as the silk, crimson curtains blew wildly."

Metaphor is when two unlike things are compared without the use of "like" or "as." EXAMPLE: "The tree was a sentinel guarding the dog house," or "The stars were diamonds in the night sky."

Onomatopoeia is the use of words that mimic sounds. They appeal to our sense of hearing and they help bring a description to life. EXAMPLE: "buzz," "meow," or "crackle."

Personification is when qualities of a person are attributed to an animal, an object, or an idea. EXAMPLE: "The stars danced in the night sky," or "The time ran away from us."

Simile is when two unlike things are compared using "like" or "as." EXAMPLE: "The stars were like diamonds in the night sky." or "He was as strong as an ox."

Point of View:

Whenever an author writes a piece of literature, he/she must decide to write in first-person, third-person limited, or third-person omniscient point of view. "Omniscient" means **all-knowing**.

In **first-person** point of view, the narrator is a character in the story. He or she will refer to him/herself as "I," and he/she will interact with other characters in the tale.

In **third-person limited** point of view, the narrator is telling a story about other characters, and he/she will only know the thoughts and feelings of the main character.

In **third-person omniscient** point of view, the narrator is telling a story about other characters, and he/she will know the thoughts and feelings of multiple characters. In this case, the narrator is omniscient, or all-knowing. **Pronouns such as "he" or "she" will be used to describe the characters in third-person point of view.**

SCIENCE *weights & measures & formulas*



WEIGHTS AND MEASURES

ENGLISH

Area

1 square foot (ft ²)	-----	144 square inches (in ²)
1 square yard (yd ²)	-----	9 square feet
1 acre	-----	43,560 square feet
1 square mile (mi ²)	-----	640 acres

Capacity

1 cup (c)	-----	8 fluid ounces (fl oz)
1 pint (pt)	-----	2 cups
1 quart (qt)	-----	2 pints
1 quart	-----	4 cups
1 gallon (gal)	-----	4 quarts

Length

1 foot (ft)	-----	12 inches (in)
1 yard (yd)	-----	36 inches
1 yard	-----	3 feet
1 mile (mi)	-----	5,280 feet
1 mile	-----	1,760 yards

Time

1 minute (min)	-----	60 seconds (s)
1 hour (h)	-----	60 minutes
1 day (d)	-----	24 hours
1 week (wk)	-----	7 days
1 year (yr)	-----	12 months (mo)
1 year	-----	52 weeks
1 year	-----	365 days
1 century (c)	-----	100 years

Weight

1 pound (lb)	-----	16 ounces (oz)
1 short ton (T)	-----	2,000 pounds

FORMULAS

Perimeter of a rectangle	-----	$P = 2(l+w)$
Perimeter of a square	-----	$P = 4s$
Perimeter of a regular polygon	-----	$P = ns$
		(n = number of sides)
Area of a rectangle	-----	$A = lw$
Area of a square	-----	$A = s^2$
Area of a parallelogram	-----	$A = bh$
Area of a triangle	-----	$A = \frac{1}{2}bh$
Area of a trapezoid	-----	$A = \frac{1}{2}h(b_1 + b_2)$
Area of a circle	-----	$A = \pi r^2$
Circumference of a circle	-----	$C = \pi d$, or $2\pi r$
Volume of a rectangular prism	-----	$V = lwh$
Volume of any prism	-----	$V = Bh$
Volume of a cylinder	-----	$V = \pi r^2 h$
Volume of a pyramid	-----	$V = \frac{1}{3}Bh$
Volume of a cone	-----	$V = \frac{1}{3}\pi r^2 h$
Surface area of a cylinder	-----	$SA = 2\pi r^2 + 2\pi rh$
Pythagorean Theorem	-----	$a^2 + b^2 = c^2$
		(sides of a right triangle)

Simple interest	-----	$I = prt$
Distance	-----	$d = rt$

METRIC

Area

1 sq centimeter (cm ²)	-----	100 sq millimeters (mm ²)
1 sq meter (m ²)	-----	10,000 sq centimeters
1 hectare (ha)	-----	10,000 square meters
1 sq kilometer (km ²)	-----	1,000,000 sq meters

Capacity

1 milliliter (ml)	-----	.001 liter (L)
1 centiliter (cl)	-----	.01 liter
1 deciliter (dl)	-----	.1 liter
1 dekaliter (dal)	-----	10 liters
1 hectoliter (hl)	-----	100 liters
1 kiloliter (kl)	-----	1,000 liters

Length

1 millimeter (mm)	-----	.001 meter (m)
1 centimeter (cm)	-----	.01 meter
1 decimeter (dm)	-----	.1 meter
1 dekameter (dam)	-----	10 meters
1 hectometer (hm)	-----	100 meters
1 kilometer (km)	-----	1,000 meters

Mass/Weight

1 milligram (mg)	-----	.001 gram (g)
1 centigram (cg)	-----	.01 gram
1 decigram (dg)	-----	.1 gram
1 dekagram (dag)	-----	10 grams
1 hectogram (hg)	-----	100 grams
1 kilogram (kg)	-----	1,000 grams
1 metric ton (t)	-----	1,000 kilograms

FORMULA KEY

A	=	area
b	=	base, length of any side of a plane figure
B	=	area of base
d	=	diameter
h	=	height, perpendicular distance from the furthest point of the figure to the extended base
l	=	length
P	=	perimeter
r	=	radius
s	=	side
sa	=	surface area
V	=	volume
w	=	width

I	=	interest, p = principal, r = rate, t = time
d	=	distance, r = rate, t = time

MATHEMATICS *fractions & percentages & multiplication table*

FRACTIONS AND PERCENTAGES

1	=	1.0	=	100%
3/4	=	0.75	=	75%
2/3	=	0.667	=	66.7%
1/2	=	0.5	=	50%
1/3	=	0.333	=	33.3%
1/4	=	0.25	=	25%
1/5	=	0.2	=	20%
1/6	=	0.167	=	16.7%
1/7	=	0.142	=	14.2%
1/8	=	0.125	=	12.5%
1/9	=	0.111	=	11.1%
1/10	=	0.1	=	10%
1/11	=	0.091	=	9.1%
1/12	=	0.083	=	8.3%

WORKING WITH FRACTIONS

The top number of a fraction is called the **numerator**.

The bottom number of a fraction is called the **denominator**.

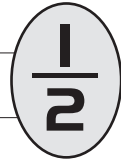

To multiply:

$$\frac{1}{2} \times \frac{3}{4} = \frac{1 \times 3}{2 \times 4} = \frac{3}{8}$$

To divide, multiply the first fraction with the reciprocal of the other:

$$\frac{2}{3} \div \frac{1}{6} = \frac{2}{3} \times \frac{6}{1} = \frac{12}{3} = 4$$

To add or subtract, first find the common denominator:

$$\frac{1}{3} + \frac{2}{5} = \frac{(1 \times 5)}{3 \times 5} + \frac{(2 \times 3)}{5 \times 3} = \frac{5}{15} + \frac{6}{15} = \frac{11}{15}$$

MULTIPLICATION TABLE

	1	2	3	4	5	6	7	8	9	10	11	12	13	14	15	16	17	18	19	20
1	1	2	3	4	5	6	7	8	9	10	11	12	13	14	15	16	17	18	19	20
2	2	4	6	8	10	12	14	16	18	20	22	24	26	28	30	32	34	36	38	40
3	3	6	9	12	15	18	21	24	27	30	33	36	39	42	45	48	51	54	57	60
4	4	8	12	16	20	24	28	32	36	40	44	48	52	56	60	64	68	72	76	80
5	5	10	15	20	25	30	35	40	45	50	55	60	65	70	75	80	85	90	95	100
6	6	12	18	24	30	36	42	48	54	60	66	72	78	84	90	96	102	108	114	120
7	7	14	21	28	35	42	49	56	63	70	77	84	91	98	105	112	119	126	133	140
8	8	16	24	32	40	48	56	64	72	80	88	96	104	112	120	128	136	144	152	160
9	9	18	27	36	45	54	63	72	81	90	99	108	117	126	135	144	153	162	171	180
10	10	20	30	40	50	60	70	80	90	100	110	120	130	140	150	160	170	180	190	200
11	11	22	33	44	55	66	77	88	99	110	121	132	143	154	165	176	187	198	209	220
12	12	24	36	48	60	72	84	96	108	120	132	144	156	168	180	192	204	216	228	240
13	13	26	39	52	65	78	91	104	117	130	143	156	169	182	195	208	221	234	247	260
14	14	28	42	56	70	84	98	112	126	140	154	168	182	196	210	224	238	252	266	280
15	15	30	45	60	75	90	105	120	135	150	165	180	195	210	225	240	255	270	285	300
16	16	32	48	64	80	96	112	128	144	160	176	192	208	224	240	256	272	288	304	320
17	17	34	51	68	85	102	119	136	153	170	187	204	221	238	255	272	289	306	323	340
18	18	36	54	72	90	108	126	144	162	180	198	216	234	252	270	288	306	324	342	360
19	19	38	57	76	95	114	133	152	171	190	209	228	247	266	285	304	323	342	361	380
20	20	40	60	80	100	120	140	160	180	200	220	240	260	280	300	320	340	360	380	400

Order of Operations

Please Excuse My Dear Aunt Sally

- 1.) Parentheses
- 2.) Exponents
- 3.) Multiply and Divide (from left to right)
- 4.) Add and Subtract (from left to right)

$$4^3 \div (16 - 12) \cdot 3 \quad (\text{parentheses})$$

$$4^3 \div 4 \cdot 3 \quad (\text{exponents})$$

$$64 \div 4 \cdot 3 \quad (\text{divide})$$

$$16 \cdot 3 \quad (\text{multiply})$$

$$48$$

Slope

$$\begin{array}{c} \updownarrow \\ \text{rise} \end{array} \quad \begin{array}{c} \updownarrow \\ \text{change in } y \end{array} \quad \frac{y_2 - y_1}{x_2 - x_1}$$

$$\begin{array}{c} \leftarrow \rightarrow \\ \text{run} \end{array} \quad \begin{array}{c} \leftarrow \rightarrow \\ \text{change in } x \end{array}$$

Sum: Add

Difference: Subtract

Product: Multiply

Quotient: Divide

Operations with Integers Rules

Add/Subtract

Same sign- find the sum (add)

Different signs- find the difference (subtract)

Check the higher number- if the higher number is positive, the

Multiply/Divide

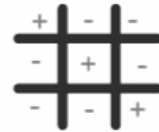

Angles

Complementary- 2 angles whose sum is 90 degrees

Supplementary- 2 angles whose sum is 180 degrees

Vertical- angles opposite each other when 2 lines intersect

Adjacent- angles that share a common side

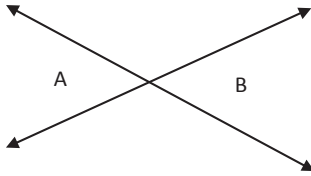

Angle A = Angle B

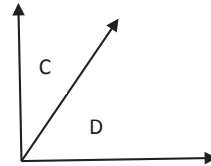

Angles C and D are adjacent.

Percent Proportion

$$\frac{\text{is}}{\text{of}} = \frac{\%}{100}$$

What number is 25% of 180?

$$\frac{x}{180} = \frac{25}{100}$$

Cross multiply and solve

Scale

Scale: 0.5 in = 2 ft
Scale model: 3 in

$$\frac{0.5 \text{ in}}{2 \text{ ft}} = \frac{3 \text{ in}}{x \text{ ft}}$$

Cross multiply and solve

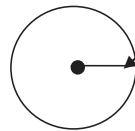

Radius: the distance across half a circle

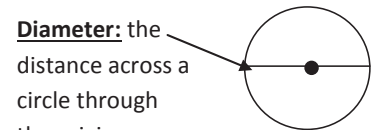

Diameter: the distance across a circle through the origin

Dimensional Analysis Steps:

- 1) Write down the information given in first fraction.
- 2) Write down what you are asked to find after the = sign.
- 3) Put in conversion factors and cross out labels.
- 4) Multiply across.

Example: Ngun buys 4 gallons of milk at the store. How many cups of milk did she buy?

$$\frac{4 \text{ gallons}}{1} \cdot \frac{4 \text{ quarts}}{1 \text{ gallon}} \cdot \frac{2 \text{ pints}}{1 \text{ quart}} \cdot \frac{2 \text{ cups}}{1 \text{ pint}} = 64 \text{ cups}$$

Prime Numbers:

2	3	5	7					
11	13		17		19			
	23				29			
31			37					
41	43		47					
	53				59			
61			67					
71	73					79		
	83		87		89			
			97					

Perfect Squares:

$1^2 = 1$	$11^2 = 121$	$21^2 = 441$
$2^2 = 4$	$12^2 = 144$	$22^2 = 484$
$3^2 = 9$	$13^2 = 169$	$23^2 = 529$
$4^2 = 16$	$14^2 = 196$	$24^2 = 576$
$5^2 = 25$	$15^2 = 225$	$25^2 = 625$
$6^2 = 36$	$16^2 = 256$	
$7^2 = 49$	$17^2 = 289$	
$8^2 = 64$	$18^2 = 324$	
$9^2 = 81$	$19^2 = 361$	
$10^2 = 100$	$20^2 = 400$	

Rational Numbers: numbers that can be written as fractions

Examples: 3 -11 1.2 2.3333333...
 $\frac{3}{4}$ $\sqrt{16}$ $-\sqrt{25}$ $7\frac{5}{6}$ -6.13

Irrational Numbers: numbers that can't be written as fractions

Examples: 3.21576892... -12.78123092...
 π $\sqrt{13}$ $-\sqrt{67}$

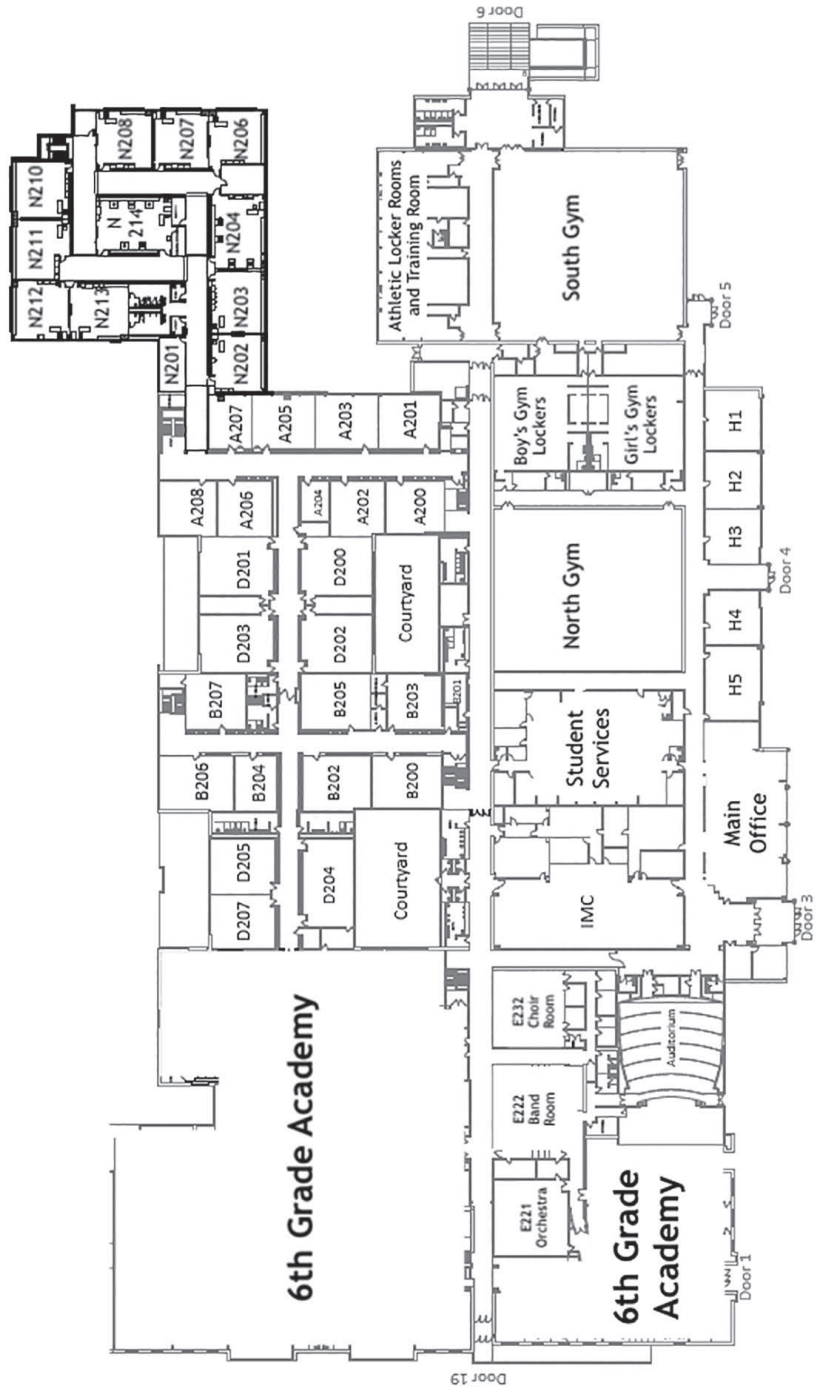

SMS/SA Building Map

Lower Level



English	Spanish	Burmese/Tedim	Swahili
Hello!	¡Hola!	Halo!.....	Jambo!
How are you?	¿Cómo estás?	Na dam hia?.....	Habari Yako?
Do you understand?	¿Entiendes? or ¿Comprendes?	Na tel hia?	Una elewa?
Do you have a question?	¿Tienes una pregunta?	Na dot nop a om hia?	Una swali?
Do you need help?	¿Necesitas ayuda?	Huhna/ huhding na ki sam hia?.....	Je, una hitaji msaada?
Do you feel sick?	¿Te sientes enfermo/ enferma?*	Na ci na nuam a hia?	Unajisikia mgonjwa?
Are you hurt?	¿Estás herido/herida?*	Na sa na hia?	Umeumia?
Show me where it hurts.	Muéstrame dónde tienes dolor.	Na koi teng na hiam nong lak thei dia?	Nionyeshe ni wapi inaumiza?
Please.	Por favor.	Hehpihna tawh....	Tafadhali
Listen.	Escucha./Escuchen. ••	Na ngai...	Sikiza
Thank you!	¡Gracias!	Ka lungdam ei..	Asante
Great job!	¡Buen trabajo!	Na sep dan siamlua/hoih lua.....	Kazi njema
pencil	lápiz	laikung malngat/Khedan	Penseli
pen	bolígrafo	Laikung...	Kalamu
paper	papel	laidal	Karatasi
notebook	cuaderno	ciaptehna bu/ laigelhna bu...	Kitabu
calculator	calculadora	Lai tuatna	Kikokotozi
computer	computadora	Computer	Kompyuta
homework	tarea	Inn lai bawl	Masomo ya nyumbani
quiz	prueba	Lai huan neu....	Jaribio
test	examen	Lai huanpi	Mtihani
desk	escritorio	Lai atna sabuai	Dawati
classroom	aula	Lai sina mun...	Darasa
hallway	pasillo	Lam zin....	Ukanda
locker	casillero	Laibu Bizu.....	Kabati ya vitabu
bus	autobús	Sang mawtaw.....	Basi

* Denotes that the masculine (o) or feminine (a) form of the adjective should be used in Spanish.

** Denotes that the correct command should be used in Spanish: “escucha” when addressing one person, “escuchen” when addressing a group.

ONLINE SAFETY

BE SMART! BE RESPECTFUL! BE SECURE!

The internet is a real-life place with real-life dangers. Be smart and take steps to keep yourself safe online.

Be Smart!

Everything you post online stays online forever! It can be copied, saved, and distributed by anyone. Think, before you post images or words you might regret!

Be Respectful!

When online, people sometimes forget that they are communicating with other people and not with their computer screen. They might say or do things online they would never say or do in person. These people are called cyberbullies.

Remember to treat others online as you would want to be treated. Don't say or do anything that you wouldn't say or do to someone face-to-face. Be kind, courteous, and respectful to others. Cyberbullying is serious and a crime in many states.

Be Secure!

The online world is not a game. It is real life. Keeping your personal and financial information safe is important. Here are a few tips on how to keep your information safe online:

- ✗ If it isn't required, don't fill it in.
- ✗ Keep your passwords and login information to email, social networking sites, and other accounts secret from even your best friend. Change your password(s) periodically.
- ✗ Pick a password that has numbers and letters, varied capitalization, and has more than seven characters.
- ✗ Make sure your connection is secure before logging in.
- ✗ Check the URL (www. Address) of the website you are logging into. Don't trust the appearance of the site itself.
- ✗ If you get an email about something important, research the email and make sure it isn't a scam. Don't use the email's links or download information from your email.
- ✗ Use up-to-date Antivirus software, and do regular scans for viruses.

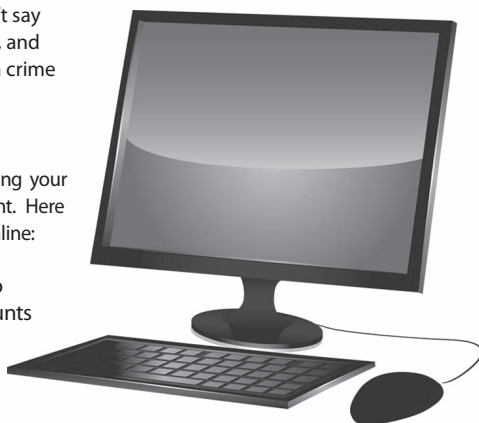

HAVE YOU OR SOMEONE YOU KNOW ...

... ever had money stolen from them online? **Discuss**

... ever posted something or had something posted they would rather not have online? **Discuss**

... ever accidentally or purposefully sent an email or text to someone and hurt their feelings? **Discuss**

Why is it important to be smart, safe, and respectful online? **Answer on a separate piece of paper.**

Class	Where do I find new learning in Canvas?	Where do I find assignments in Canvas?	What else should I know about Canvas?	What other apps/websites will I use?	How do I log into my e-textbook?
<i>Period 1:</i>					
<i>Period 2:</i>					
<i>Period 3:</i>					
<i>Period 4:</i>					
<i>Period 5:</i>					
<i>Period 6:</i>					
<i>Period 7:</i>					